



CoreLine Projector gen2

ST151T LED30S/930 MB BK

25 degree(s), 930 warm white, Power supply unit (On/Off), Black

The well-known CoreLine Projector with its latest generation has undergone important design and performance improvement, raising the bar even higher and setting a new standard for track projectors used in retail and hospitality applications.

Warnings and Safety

- The luminaire should be mounted outside of arm's reach
- The luminaire should be installed by a qualified electrician and wired in accordance with the latest IEE electrical regulations or the national requirements

Product data

General Information		Light Technical	
Light source replaceable	No	Luminous Flux	3,000 lm
Number of gear units	1 unit	Saturated Red (R9)	>50
Driver included	Yes	Correlated Color Temperature (Nom)	3000 K
Lighting Technology	LED	Luminous Efficacy (rated) (Nom)	100 lm/W
Value ladder	Value	Color rendering index (CRI)	>90
CE mark	Yes	Flickering value (PstLM) - Flickering value as per EN 61000-3-3	1
Warranty period	5 years	Stroboscopic effect visibility measure (SVM)	1.6
Flammability mark	-	Beam angle of light source	25 degree(s)
ENEC mark	ENEC mark	Light source color	930 warm white
Glow-wire test	Temperature 650 °C, duration 30 s	Optic type	Medium beam
EU RoHS compliant	Yes	Luminaire light beam spread	25°

CoreLine Projector gen2

Unified glare rating CEN	19
Operating and Electrical	
Input Voltage	220 to 240 V
Line Frequency	50 or 60 Hz
Initial CLO power consumption	30 W
Average CLO power consumption	30 W
Inrush current	43.8 A
Inrush time	0.0115 ms
Power Consumption	30 W
Power Factor (Fraction)	0.9
Connection	3C Track
Cable	-
Number of products on MCB of 16 A type B	30

Temperature	
Ambient temperature range	-20 to +40 °C

Controls and Dimming	
Dimmable	No
Driver/power unit/transformer	Power supply unit (On/Off)
Constant light output	No

Mechanical and Housing	
Housing Material	Aluminum
Reflector material	-
Optic material	Polycarbonate
Optical cover material	Polycarbonate
Fixation material	-
Housing Color	Black
Optical cover finish	-
Overall length	207 mm
Overall width	87 mm
Overall height	125 mm
Overall diameter	80 mm
Dimensions (Height x Width x Depth)	125 x 87 x 207 mm

Approval and Application	
Ingress protection code	IP20 [Finger-protected]
Mech. impact protection code	IK03 [0.3 J]
Sustainability rating	-
Protection class IEC	Safety class I
Photobiological risk	Photobiological risk group 0 @200mm to EN62778
Photobiological risk specification	0.2 m

Initial Performance (IEC Compliant)	
Luminous flux tolerance	+/-10%
Initial chromaticity	(0.4355, 0.4045) SDCM <4
Power consumption tolerance	+/-10%

Over Time Performance (IEC Compliant)	
Control gear failure rate at median useful life	0.05 %
50000 h	
Lumen maintenance at median useful life*	L70
50000 h	

Application Conditions	
Performance ambient temperature Tq	25 °C
Maximum dim level	Not applicable
Suitable for random switching	No

Product Data	
Order product name	ST151T LED30S/930 MB BK
Full product name	ST151T LED30S/930 MB BK
Full product code	871951452855099
Order code	911401846582
Material Nr. (12NC)	911401846582
Numerator - Quantity Per Pack	1
EAN/UPC - Product/Case	8719514528550
Numerator - Packs per outer box	10
EAN/UPC - Case	8719514528635

Dimensional drawing

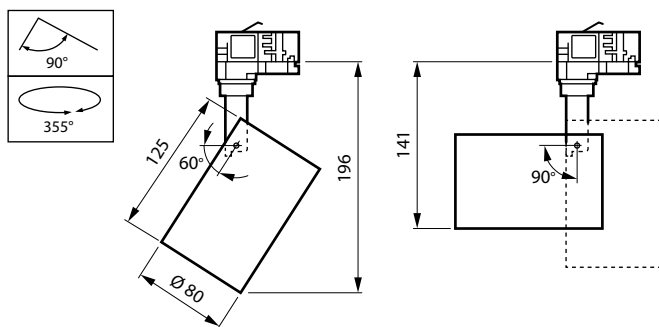

CoreLine Projector gen2

