

| | | | | | |
|-------------|--|-----------|--|------|--|
| Project | | Catalog # | | Type | |
| Prepared by | | Notes | | Date | |



Greengate

Input / Output Device

Provides connection of any Greengate low voltage occupancy sensor, or other low voltage maintain closure, to the Room Controller or DLVP power module

Typical Applications

Office • Education • Healthcare • Hospitality • Retail

Interactive Menu

- Order Information [page 2](#)
- Additional Resources [page 3](#)
- Wiring Diagrams [page 3](#)
- Connected Systems [page 6](#)
- Product Warranty

Product Certification



Top Product Features

- Input/Output integration
- Automatically provide Egress or HVAC integration based on room occupancy junction box
- Allows connection of standard switchpacks
- Plenum Rated

Dimensional Details

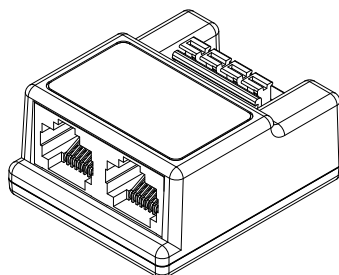
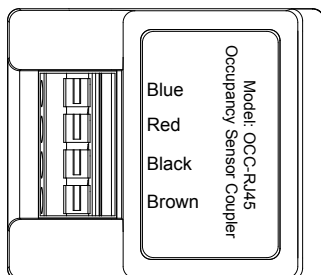

Order Information

Catalog Number

| Catalog Number | Description |
|---|---------------------|
| OCC-RJ45 | Input/Output Device |
| Notes (1) One OCC-RJ45 is automatically included with each occupancy sensor when the Room Controller is ordered as a QuickKit. (2) See Greengate low voltage occupancy sensor spec sheet for occupancy sensor information. | |

Product Specifications

Key Features

- The Input/Output Device (OCC-RJ45) provides connection of any Greengate low voltage occupancy sensor, or other low voltage maintain closure, to the Room Controller or DLVP power module to define the occupancy state of the space. The OCC-RJ45 also can be used as an output to the HVAC system, third party systems or switchpacks based upon room occupancy status.
- The Input/Output Device (OCC-RJ45) is ready and works immediately upon power up, providing Occupancy based inputs or outputs out-of-the-box, removing the need for field programming and reducing installation time
- Low-voltage devices are connected using provided pre-terminated control cables (ordered separately)

Electrical

Voltage: 24 VDC supplied from Room Controller, DLVP power module or Switchpack

Electrical Rating: Class 2, LPS

Standards/Ratings

- cULus Listed
- UL 508 Listed

Warranty

Consult website for warranty information

Mechanical

Environment:

- Operating temperature:** 32°F to 104°F (0°C to 40°C)
- Less than 95%, non-condensing
- For indoor use only

Wiring Diagrams

Sample Room Controller Wiring Diagram

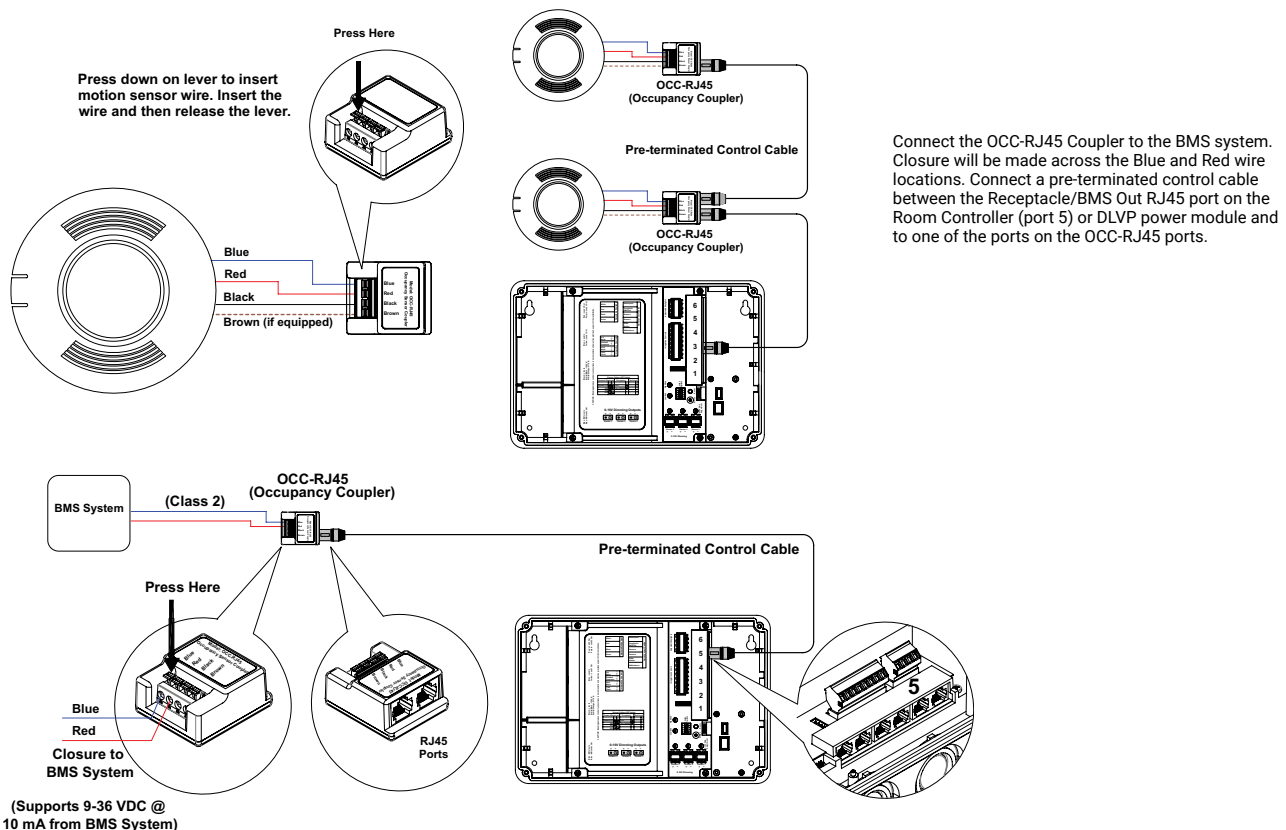

Sample DLVP Wiring Diagram

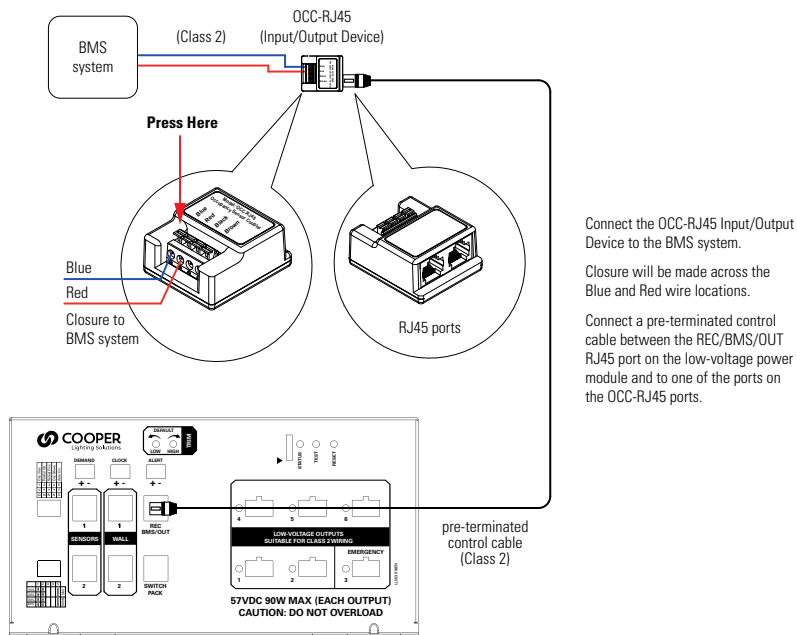
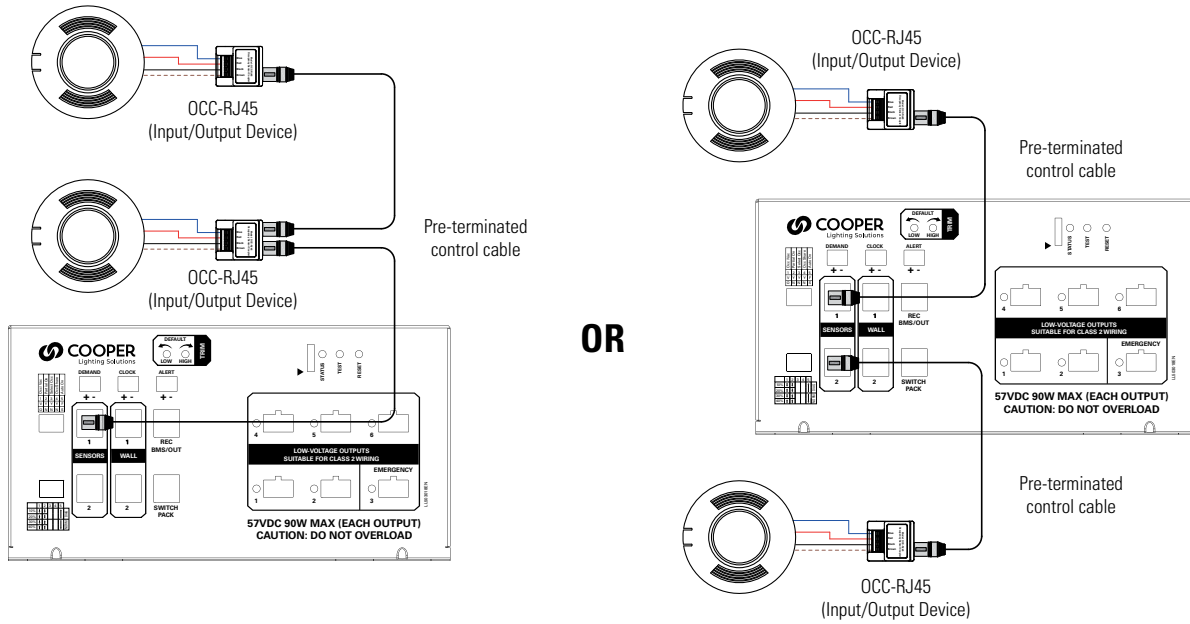

Connect the OCC-RJ45 Input/Output Device to the BMS system.

Closure will be made across the Blue and Red wire locations.

Connect a pre-terminated control cable between the REC/BMS/OUT RJ45 port on the low-voltage power module and to one of the ports on the OCC-RJ45 ports.

Sample System Topology

Sample Room Controller System Topology

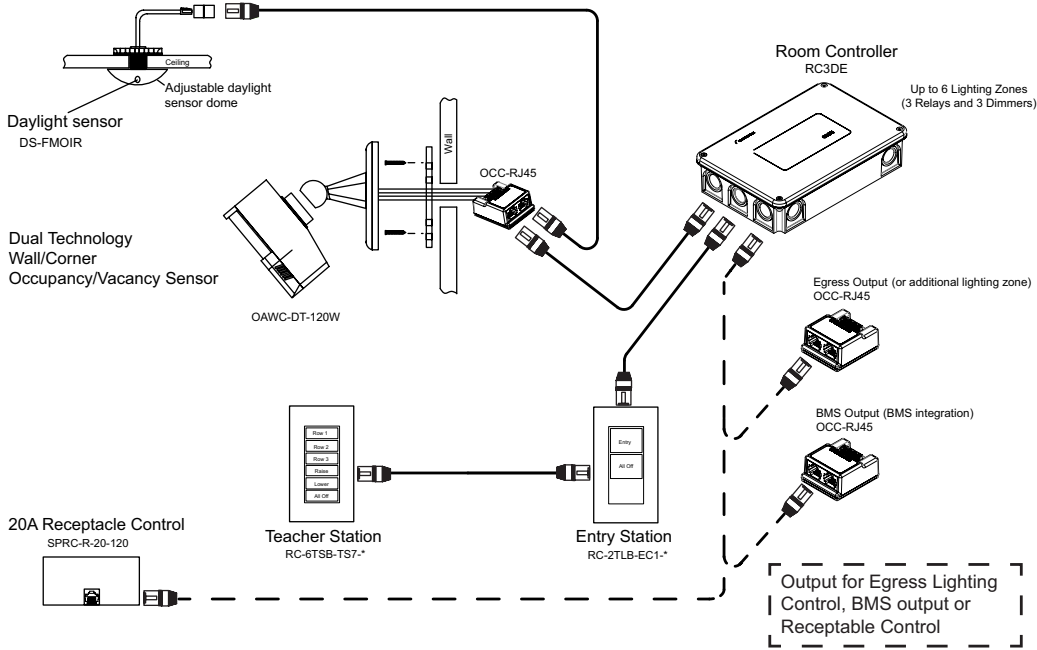

Sample DLVP System Topology

