

DESCRIPTION

When AC power fails, the Sure-Lites Emergency Battery Pack (EBP) automatically switches to emergency mode. The EBP maintains illumination of one or two lamps for a minimum of 90 minutes. The product line is UL924 listed for field retrofit installation.

Catalog #		Type
Project		
Comments		Date
Prepared by		

SPECIFICATION FEATURES

Electronic

- EBP450/EBP700/EBP1400: multi voltage input 120/240/277 VAC, 50/60Hz
- Sinusoidal AC output improving lamp longevity
- Isolated auxiliary relay with debounce technology provides compatibility with T5 ballasts
- Low-voltage disconnect protects the lamp and battery
- Capacitive coupled charging circuit
- Test Button/Indicator Light included
- Single wire multi voltage input simplifies installation

Construction

- Rugged steel canister
- Low profile height
- Terminal block connections for easy installation
- Lead wires provided

Battery

- Sealed Nickel Cadmium
- Maintenance-free, Long-life
- Full Recharge Time, 24 hours (max.) at 60Hz
- From 20°C to 55°C operating temperature range

Code Compliance

- UL 924 Listed
- Life Safety NFPA 101
- NEC/OSHA
- Most State and Local Codes

Warranty

- 5-Year warranty

EBP450X / EBP700X

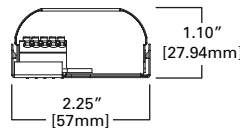
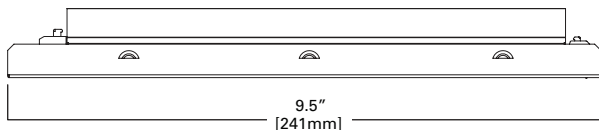
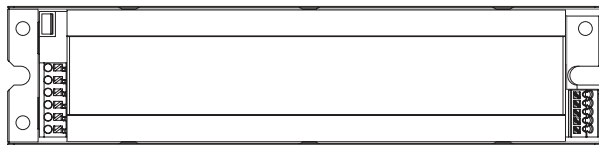

EBP1400NCX

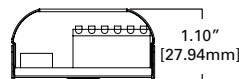
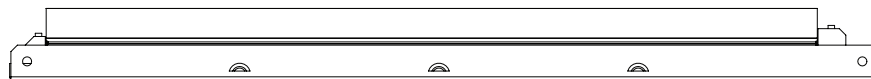
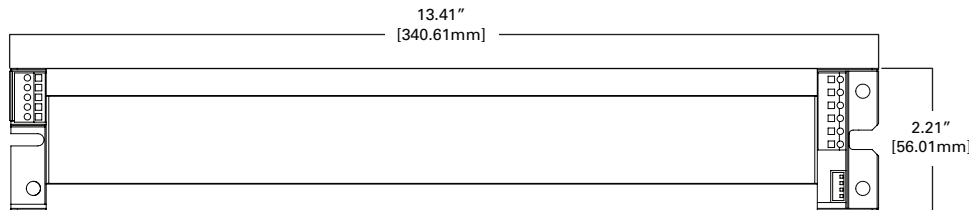

EBP450X / EBP700X



EBP1400NCX

EBP SERIES FLUORESCENT

EMERGENCY BATTERY PACK
EMERGENCY LIGHTING

ENERGY DATA

Input Power
Model No. 120V
 EBP450X = 3.1W
 EBP700X = 3.4W
 EBP1400NCX = 5.0W

ORDERING INFORMATION

SAMPLE NUMBER: EBP700X

Series

EBP450X
EBP700X
EBP1400NCX

AVERAGE LUMEN RATINGS

EBP450X	
Lamp	1 Lamp
F17 T8	390
F28 T8	520
F32 T8	540
28W T5	440
F15 T12	na
F20 T12	na
F40 T12	420
40W Long Compact	450
40W Circline	310

EBP700X		
Lamp	1 Lamp	2 Lamps
F17 T8	510	630
F28 T8	750	430
F32 T8	790	450
8' T8 (F096) (59W)	850	
F20 T12	250	400
F40 T12	600	430
8' T12 (F96T12) (60W)	700	
40W Long Compact	620	
50W Long Compact	440	
55W Long Compact	470	
20W Circline	170	
22W Circline T9	210	
22W Circline T5	300	
40W Circline T8	500	
40W Circline T5	500	
55W Circline T5	560	

EBP1400NCX			
Lamp	1 Lamp	Lamp	1 Lamp
F15 T8	460	13W T5	630
F17 T8	720	14W T5	900
F28 T8	1190	21W T5	1380
F32 T8	1390	25W T5	1350
F59 T8	460	28W T5	850
F86 T8	1170	35W T5	940
F20 T12	480	24W T5HO	870
F34 T12	890	39W T5HO	1250
F40 T12	1300	54W T5HO	810
F55 T12	740	80W T5HO	910
F60 T12	1190	22W Circline T5	840
F75 T12	890	40W Circline T5	1280
F75 T12	590	55W Circline T5	1130
F95 T12	750	F32 T8U	1250
F35 T12HO	340	18W Biax	620
F95 T12HO	820	39W Biax	920
F110 T12HO	920	40W Biax	1190
F215 T12VHO	800	55W Biax	990

TECHNICAL DATA

Single Wire Multi Voltage Input

Unit is supplied with a capacitive coupled charging circuit which automatically detects the voltage level of the AC input (120/240/277) and adjusts accordingly.

Sinusoidal AC Output

Sinusoidal AC output provides cleaner output to the lamps which improves lamp life, provides compatibility with T5 lamps, and creates more even illumination as compared to pulse DC designs.

Isolated Auxiliary Relay

The isolated auxiliary relay provides a smoother transition from AC power to emergency power and back to AC power when it is restored, which allows the EBP product to be compatible with more ballast types including ballasts with open cathode end of life detection.

Automatic Switching

The switching circuitry is designed to detect an absence of AC power and automatically transitions to emergency operation. Upon restoration of AC power the lamps will automatically switch back to operating from the AC ballast.

Test Button/Indicator Light

Simulates interruption of AC power and illuminates the fluorescent lamp(s) from the battery. LED charge light indicates the battery is charging.

Construction and Components

The canister has a reduced profile across all EBP product types which enables more mounting flexibility including most 2'x2' fixtures. "Wire bundle covers" are included for external mounting.

Terminal Blocks

The terminal block design provides easier, faster and better connections as compared to traditional designs.

Battery

High temperature nickel cadmium battery pack is standard.

Warranty

All Sure-Lites EBP products are backed by a firm five-year warranty against defects in material and workmanship (excluding lamps).