

## Dismantling Recommendation on Disposal at End of Life

### Composition Explanation

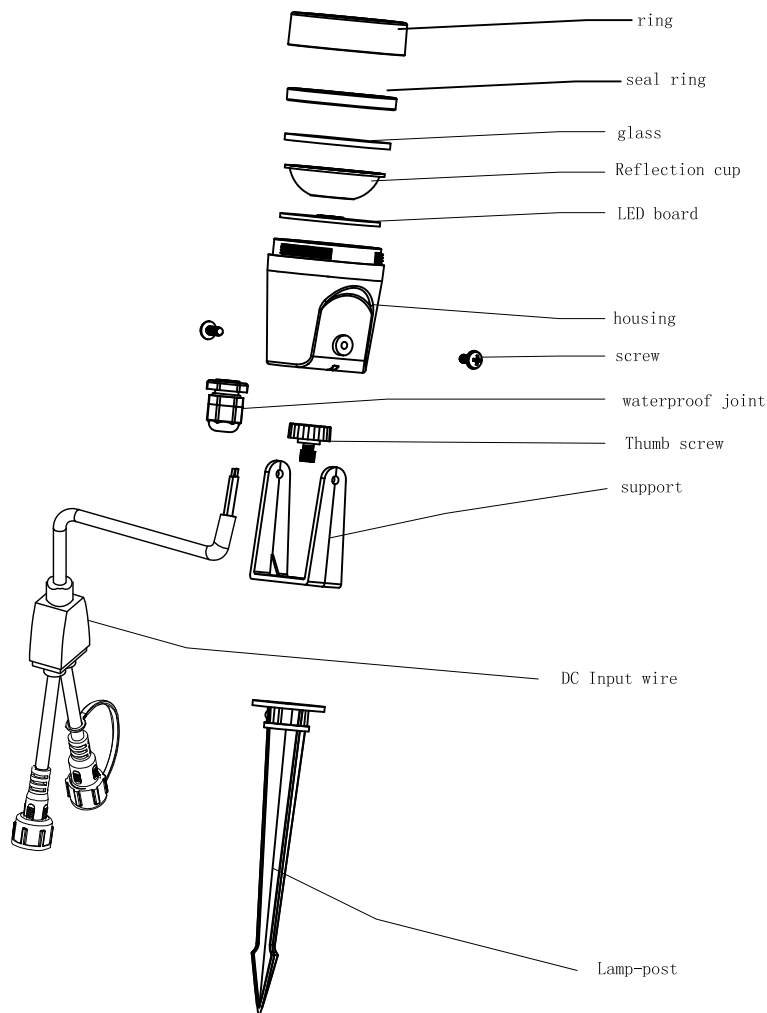

## Dismantling Recommendation on Disposal at End of Life

### Dismantling

- . Type:Luminaire permanent damage

### Recommendation on Disposal

- . Plastic part: Reuse and Recycling
- . Electrical part: Incineration and disposal
- . Metal part: Recycling

### Dismantle instruction(Light Source non replaceable)

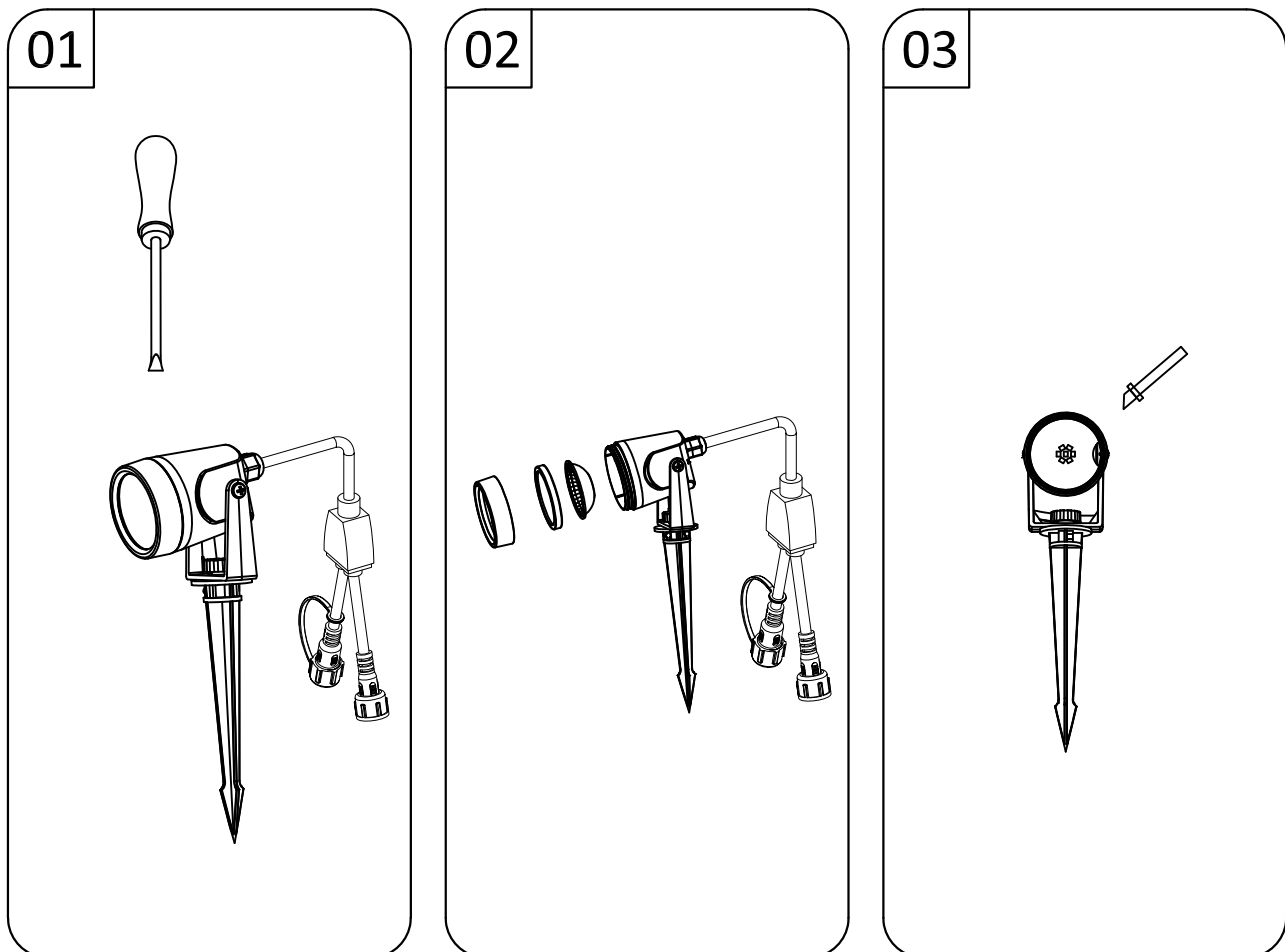

## Dismantling Recommendation on Disposal at End of Life

Light Source\*1

