

Dismantling Recommendation on Disposal at End of Life

Composition Explanation

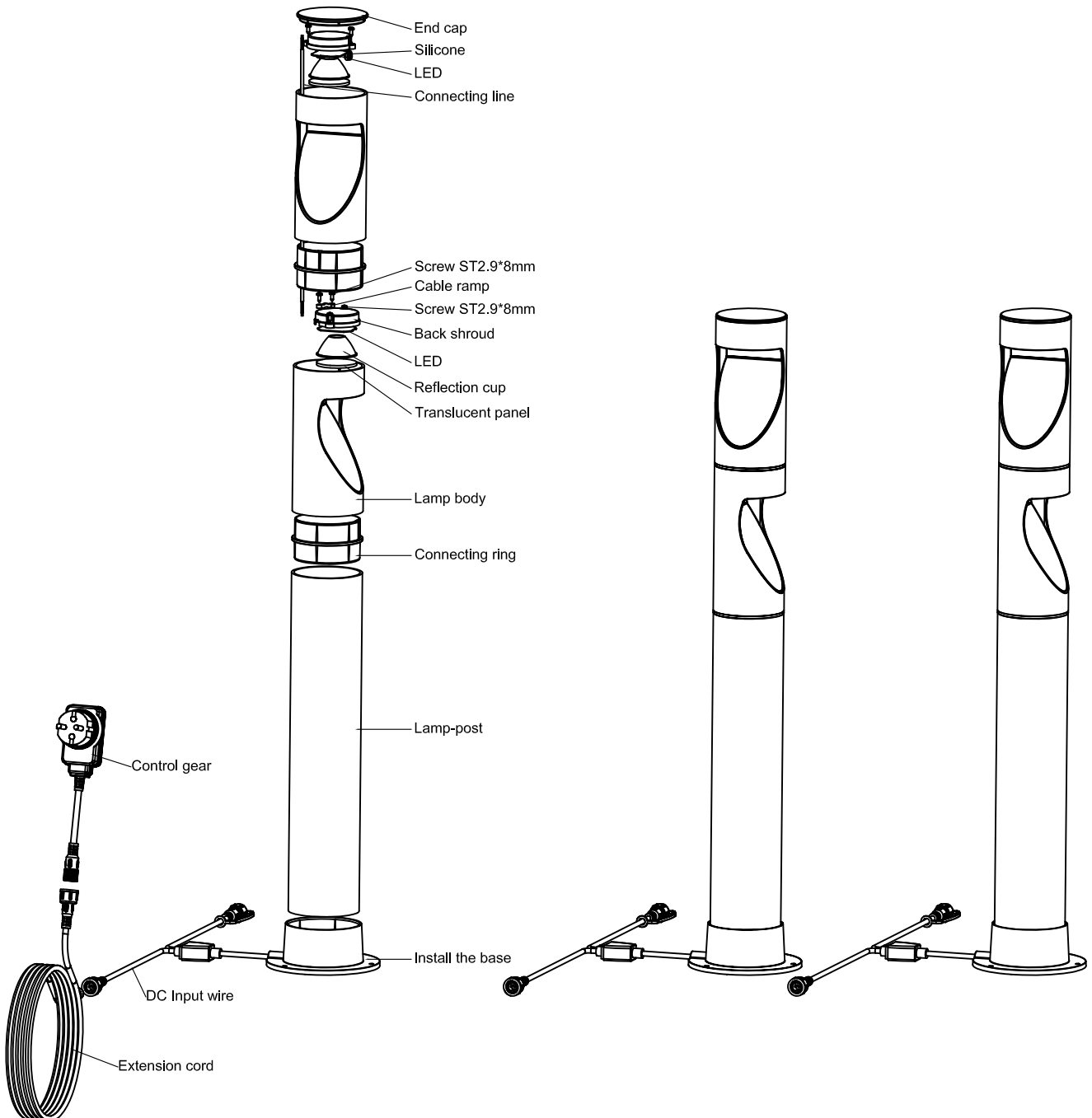

12NC: 929004659701

Dismantling Recommendation on Disposal at End of Life

Dismantling

- . Type:Luminaire permanent damage

Recommendation on Disposal

- . Plastic part: Reuse and Recycling
- . Electrical part: Incineration and disposal
- . Metal part: Recycling

Dismantle instruction(Light Source non replaceable)

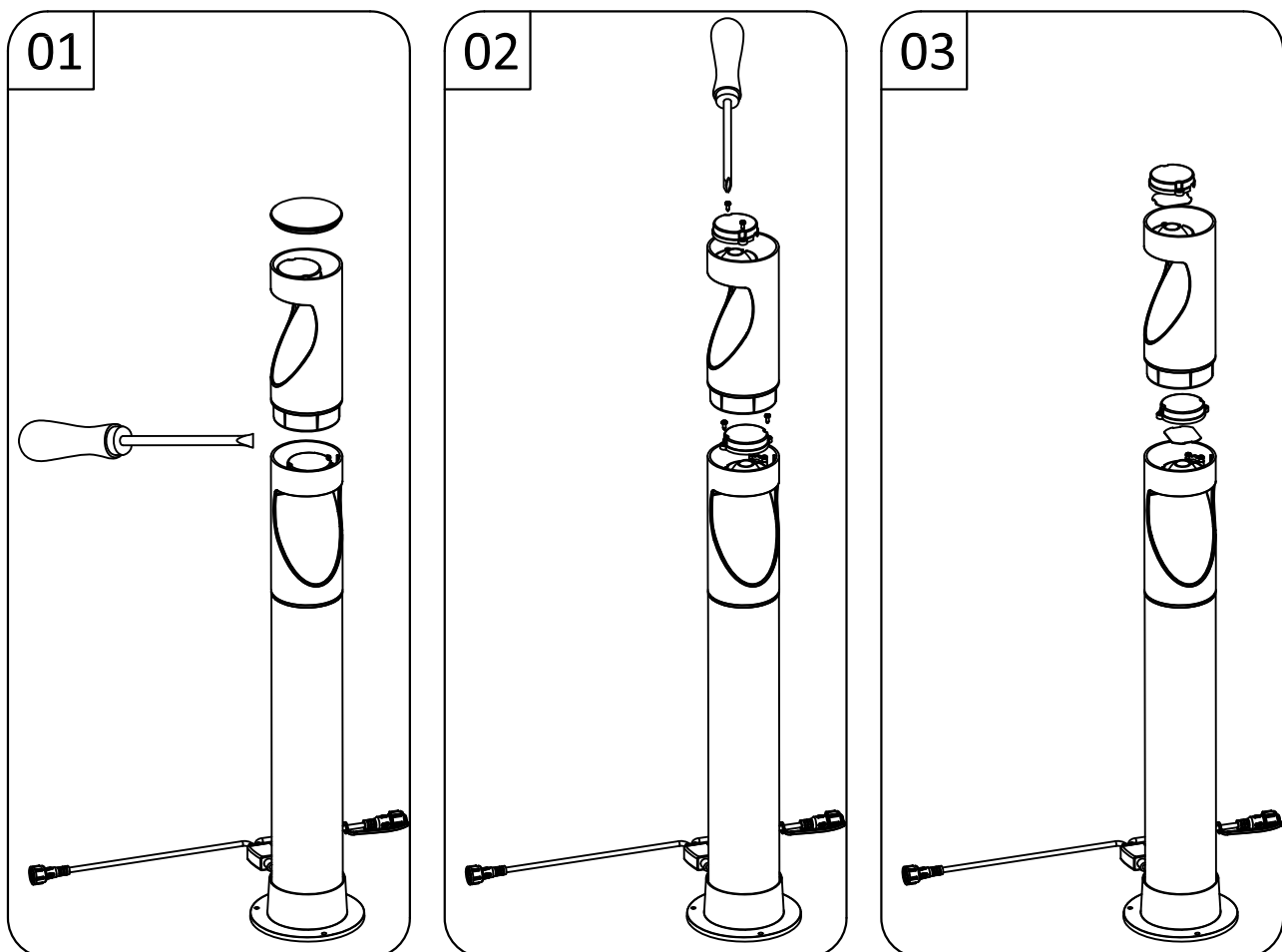

12NC:929004659701

Dismantling Recommendation on Disposal at End of Life

Light Source*6

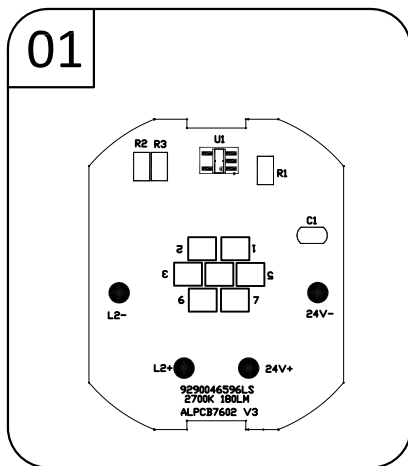

12NC: 929004659701