

Signify  
NatureConnect

NatureConnect  
link

LP912P NC2 CONTENT GENERATOR





100 V  
240V

50 Hz  
60 Hz

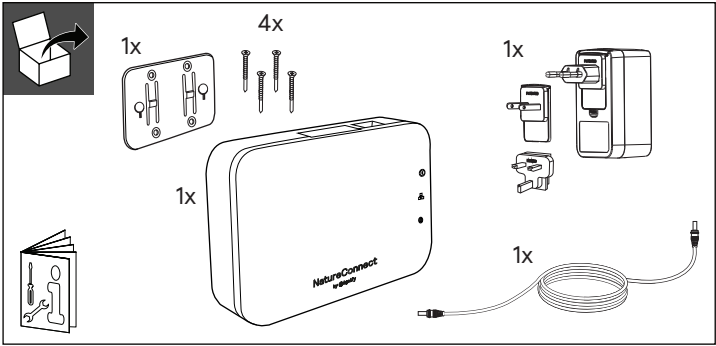

max 35°C  
min 0°C



	Power	Current	Dimensions LxWxH	
NatureConnect link	15 W	0.525 A	162x110x37 mm	0.5 kg

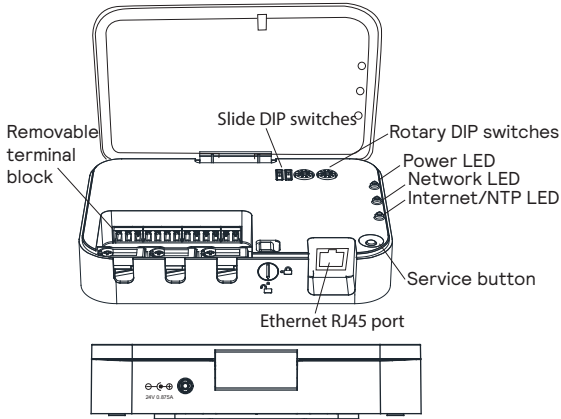
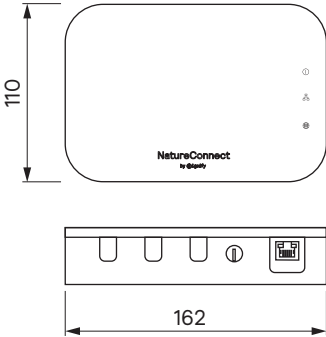

Wall mount

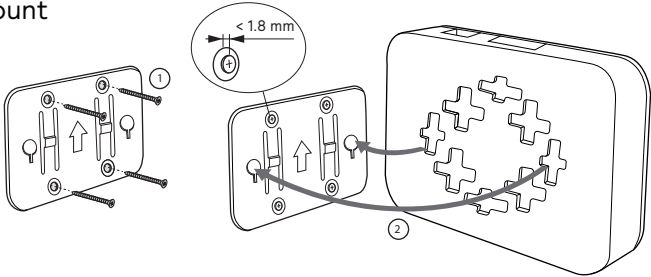

1



Open the cover

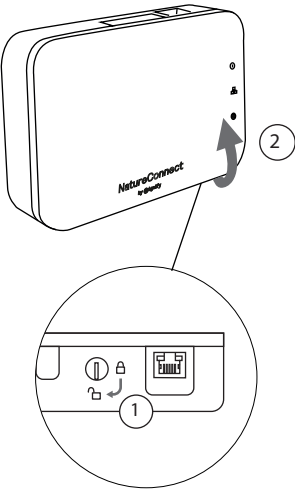

2

Wiring

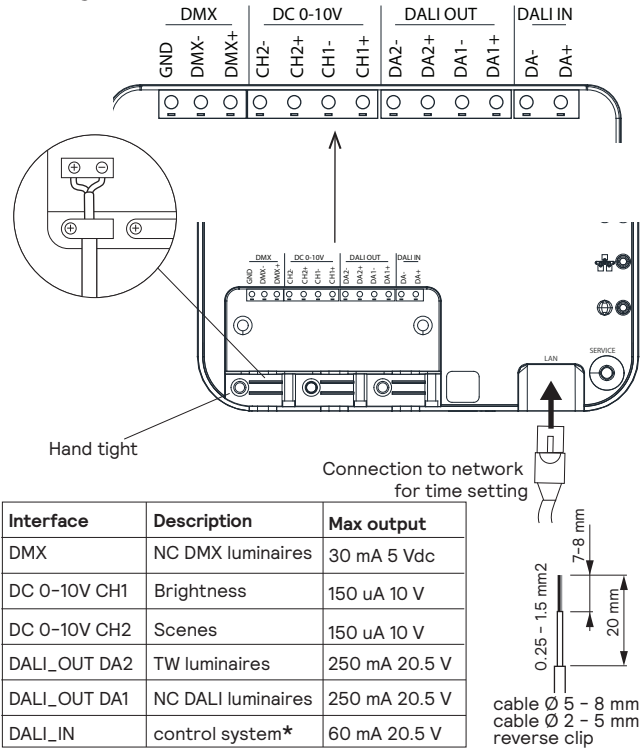

3

\*For Interact pro installation check pages 6 and 7 of this document.

Set DIP switch A for selection between DALI or 0-10 V

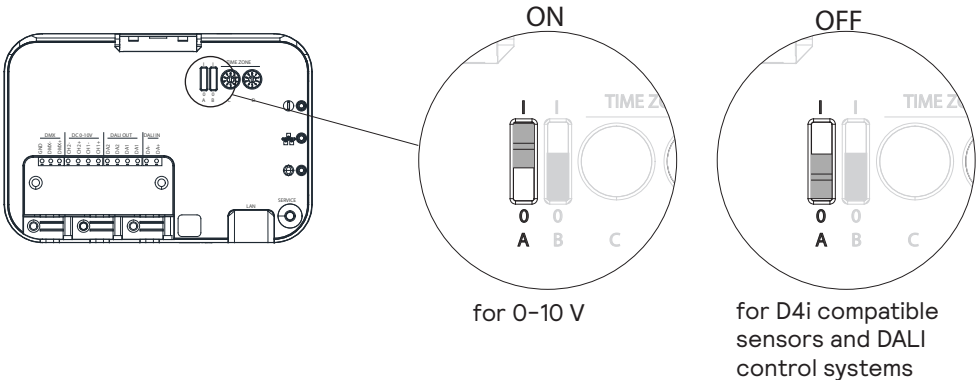

4a



Set DIP switch B for power supply of DALI\_IN

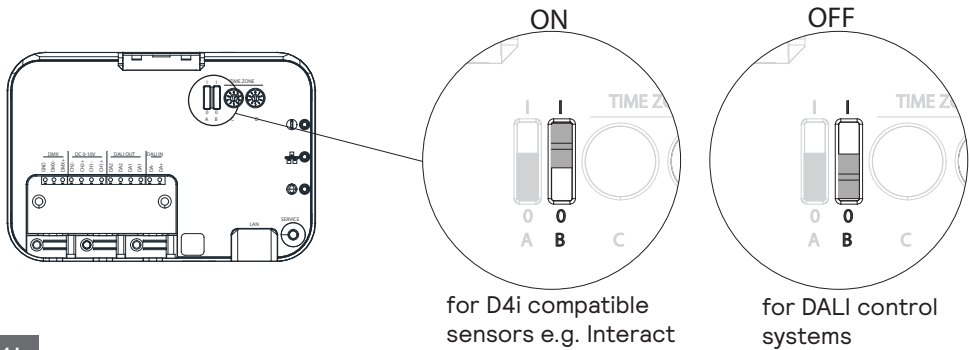

4b

Set the rotary switches for the time zone according the Time zone table

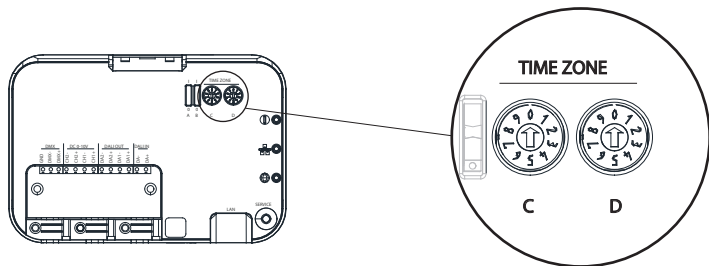

Example: setting the time zone for Prague

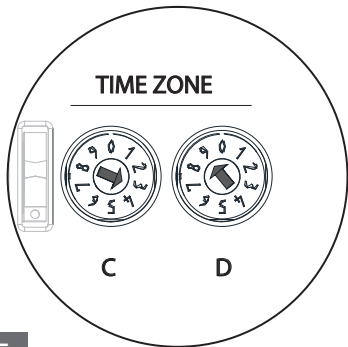

3 9 (UTC+01:00) Belgrade, Bratislava, Budapest, Ljubljana, Prague

5



Time zone table

C	D	Time zone
0	0	(UTC-08:00) Baja California
0	1	(UTC-08:00) Co-ordinated Universal Time-08
0	2	(UTC-08:00) Pacific Time (US & Canada)
0	3	(UTC-07:00) Arizona
0	4	(UTC-07:00) Chihuahua, La Paz, Mazatlan
0	5	(UTC-07:00) Mountain Time (US & Canada)
0	6	(UTC-07:00) Yukon
0	7	(UTC-06:00) Central America
0	8	(UTC-06:00) Central Time (US & Canada)
0	9	(UTC-06:00) Easter Island
1	0	(UTC-06:00) Guadalajara, Mexico City, Monterrey
1	1	(UTC-06:00) Saskatchewan
1	2	(UTC-05:00) Bogota, Lima, Quito, Rio Branco
1	3	(UTC-05:00) Chetumal
1	4	(UTC-05:00) Eastern Time (US & Canada)
1	5	(UTC-05:00) Haiti
1	6	(UTC-05:00) Havana
1	7	(UTC-05:00) Indiana (East)
1	8	(UTC-05:00) Turks and Caicos
1	9	(UTC-04:00) Asuncion
2	0	(UTC-04:00) Atlantic Time (Canada)
2	1	(UTC-04:00) Cuiaba
2	2	(UTC-04:00) Georgetown, La Paz, Manaus, San Juan
2	3	(UTC-04:00) Santiago
2	4	(UTC-03:00) Araguaina
2	5	(UTC-03:00) Brasilia
2	6	(UTC-03:00) Cayenne, Fortaleza
2	7	(UTC-03:00) City of Buenos Aires
2	8	(UTC-03:00) Greenland
2	9	(UTC-03:00) Montevideo
3	0	(UTC-03:00) Punta Arenas
3	1	(UTC-03:00) Saint Pierre and Miquelon
3	2	(UTC-03:00) Salvador
3	3	(UTC) Co-ordinated Universal Time
3	4	(UTC+00:00) Dublin, Edinburgh, Lisbon, London
3	5	(UTC+00:00) Monrovia, Reykjavik
3	6	(UTC+00:00) Sao Tome
3	7	(UTC+01:00) Casablanca
3	8	(UTC+01:00) Amsterdam, Berlin, Bern, Rome, Stockholm, Vienna
3	9	(UTC+01:00) Belgrade, Bratislava, Budapest, Ljubljana, Prague
4	0	(UTC+01:00) Brussels, Copenhagen, Madrid, Paris
4	1	(UTC+01:00) Sarajevo, Skopje, Warsaw, Zagreb
4	2	(UTC+01:00) West Central Africa
4	3	(UTC+02:00) Athens, Bucharest
4	4	(UTC+02:00) Beirut
4	5	(UTC+02:00) Cairo
4	6	(UTC+02:00) Chisinau
4	7	(UTC+02:00) Damascus
4	8	(UTC+02:00) Gaza, Hebron
4	9	(UTC+02:00) Harare, Pretoria

C	D	Time zone
5	0	(UTC+02:00) Helsinki, Kyiv, Riga, Sofia, Tallinn, Vilnius
5	1	(UTC+02:00) Jerusalem
5	2	(UTC+02:00) Juba
5	3	(UTC+02:00) Kaliningrad
5	4	(UTC+02:00) Khartoum
5	5	(UTC+02:00) Tripoli
5	6	(UTC+02:00) Windhoek
5	7	(UTC+03:00) Amman
5	8	(UTC+03:00) Baghdad
5	9	(UTC+03:00) Istanbul
6	0	(UTC+03:00) Kuwait, Riyadh
6	1	(UTC+03:00) Minsk
6	2	(UTC+03:00) Moscow, St Petersburg
6	3	(UTC+03:00) Nairobi
6	4	(UTC+03:00) Volgograd
6	5	(UTC+03:30) Tehran
6	6	(UTC+04:00) Abu Dhabi, Muscat
6	7	(UTC+04:00) Astrakhan, Ulyanovsk
6	8	(UTC+04:00) Baku
6	9	(UTC+04:00) Izhevsk, Samara
7	0	(UTC+04:00) Port Louis
7	1	(UTC+04:00) Saratov
7	2	(UTC+04:00) Tbilisi
7	3	(UTC+04:00) Yerevan
7	4	(UTC+05:00) Ashgabat, Tashkent
7	5	(UTC+05:00) Ekaterinburg
7	6	(UTC+05:00) Qyzylorda
7	7	(UTC+05:30) Chennai, Kolkata, Mumbai, New Delhi
7	8	(UTC+05:30) Sri Jayawardenepura
7	9	(UTC+06:00) Dhaka
8	0	(UTC+06:00) Nur-Sultan
8	1	(UTC+06:30) Yangon (Rangoon)
8	2	(UTC+07:00) Bangkok, Hanoi, Jakarta
8	3	(UTC+07:00) Barnaul, Gorno-Altaysk
8	4	(UTC+07:00) Hovd
8	5	(UTC+08:00) Beijing, Chongqing, Hong Kong SAR, Urumqi
8	6	(UTC+08:00) Kuala Lumpur, Singapore
8	7	(UTC+08:00) Perth
8	8	(UTC+08:00) Taipei
8	9	(UTC+08:00) Ulaanbaatar
9	0	(UTC+08:45) Eucla
9	1	(UTC+09:00) Chita
9	2	(UTC+09:00) Osaka, Sapporo, Tokyo
9	3	(UTC+09:00) Pyongyang
9	4	(UTC+09:00) Seoul
9	5	(UTC+09:30) Darwin
9	6	(UTC+10:00) Brisbane
9	7	(UTC+10:00) Canberra, Melbourne, Sydney
9	8	(UTC+10:00) Guam, Port Moresby
9	9	(UTC+10:00) Hobart



## Connect to power

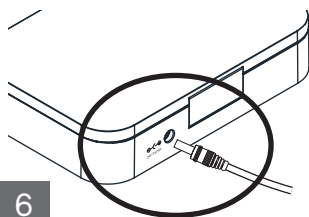

6

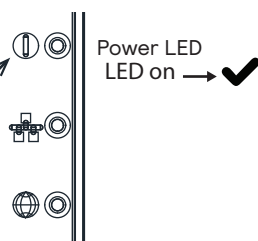
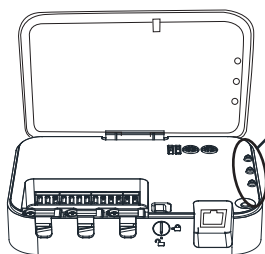

## Test the connection with the luminaires by pressing the service button

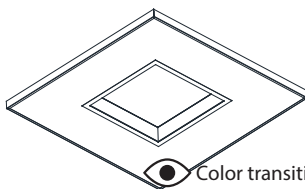
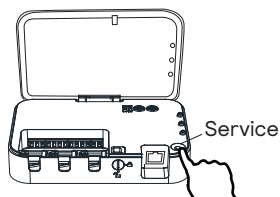

Color transition = ✓

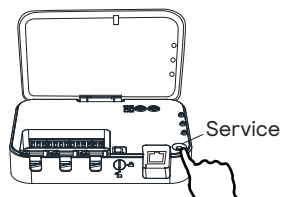

- 1 Press the "service" button to start the test

- 2 Check luminaires

- 3 Press the "service" button to finish the test

7

## Time configuration - two methods

- ! Time is already configured from production date 23W48.  
Please check on the box label.

- 1 Connect (temporarily) to a wired network that has access to internet/NTP

- 2 Manually set the time with Windows configuration app

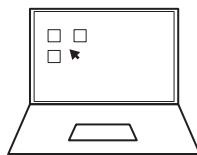
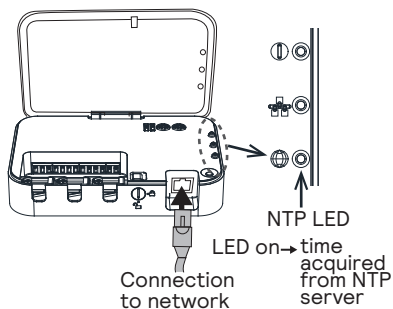

find link at page 12

! Once the time is set, NatureConnect link will keep the time without permanent internet connection.

8

## Close the cover

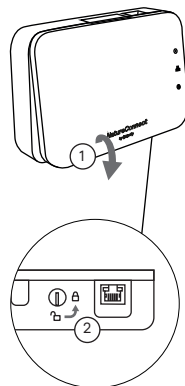

9



## LED legend

LED 1 (Red) Power status:

- OFF when no power to the device
- ON when power is on

LED 2 (Blue) Network status (only after booting finished):

- OFF when no network link
- BLINKING when network link available but no IP address assigned
- ON when network link available and IP address assigned

LED 3 (Yellow) NTP status and Booting status

- OFF when still booting
- BLINKING the device has been boot up completely but it is not connected to NTP server
- ON The device has been boot up completely and is connected to NTP server

## LED behavior with firmware < v1.2.2

Production date before 23W48

LED 3 (Yellow) Internet/NTP status:

- OFF when no internet
- BLINKING when internet available but NTP not available
- ON when internet and NTP available



## Network connectivity

### • (Temporary) Network connection with a router

To connect a NatureConnect link to the internet and/or a computer you need a router with a firewall and a DHCP server.

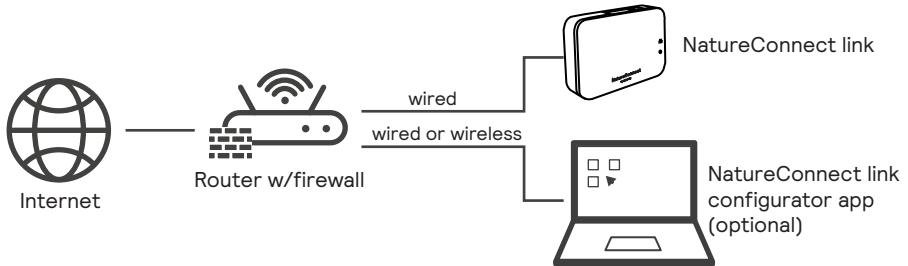

Do not connect the NatureConnect link to the internet or other networks without a firewall.



The NatureConnect link must be protected by a firewall when connecting it to the internet or other networks.



Do not connect the NatureConnect link to a shared network.

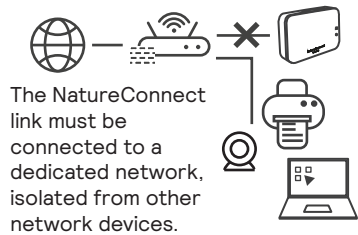

### • Temporary network connection without a router

A Windows laptop can be used to create a temporary network by bridging the Wifi and Ethernet adapter.



It's recommended to connect to a mobile hotspot.  
Security on a corporate network can prevent this set-up from working.  
This will also isolate the NC link from other devices on the local network.

### Additional notes

- For reset to factory default settings: long press (30 seconds) on Service button.
- Recommended to change the password at first use.



System architecture for Interact pro installations

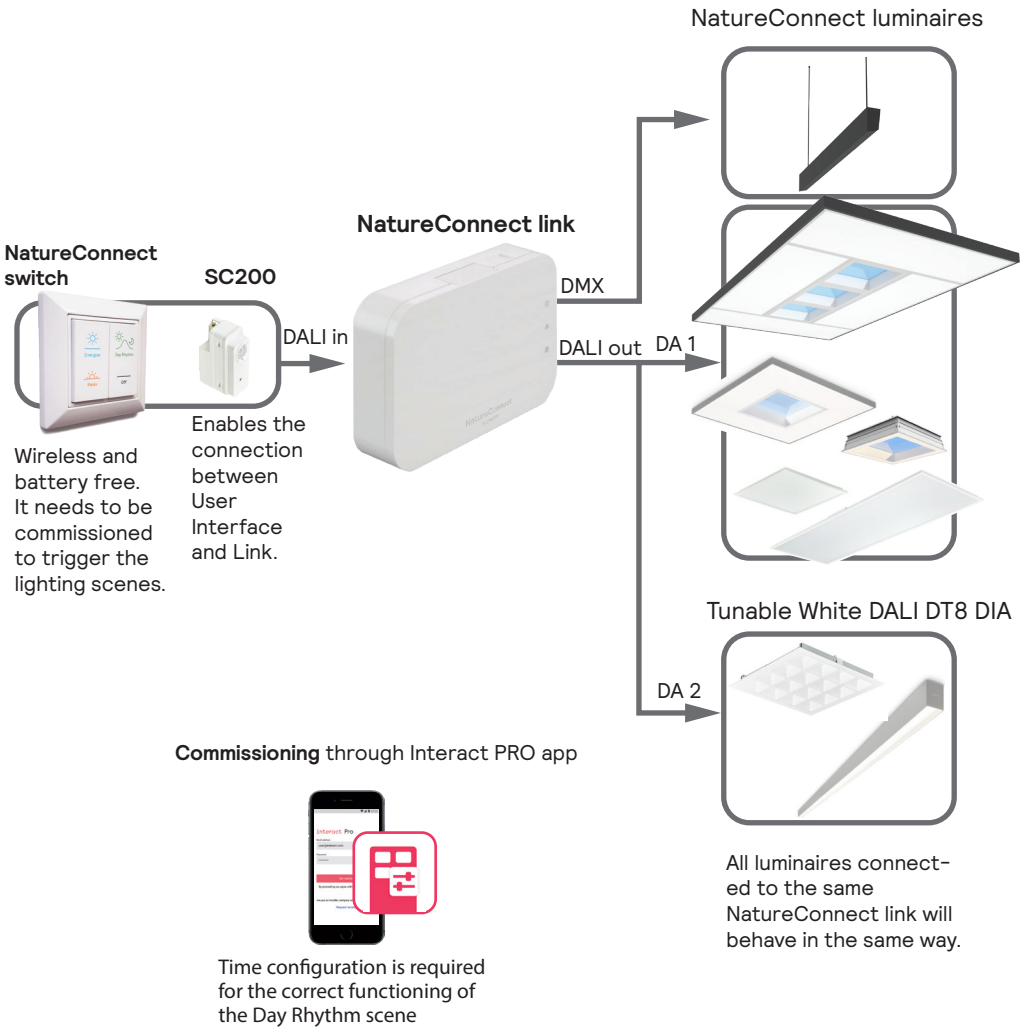



Wiring diagram for Interact pro installations

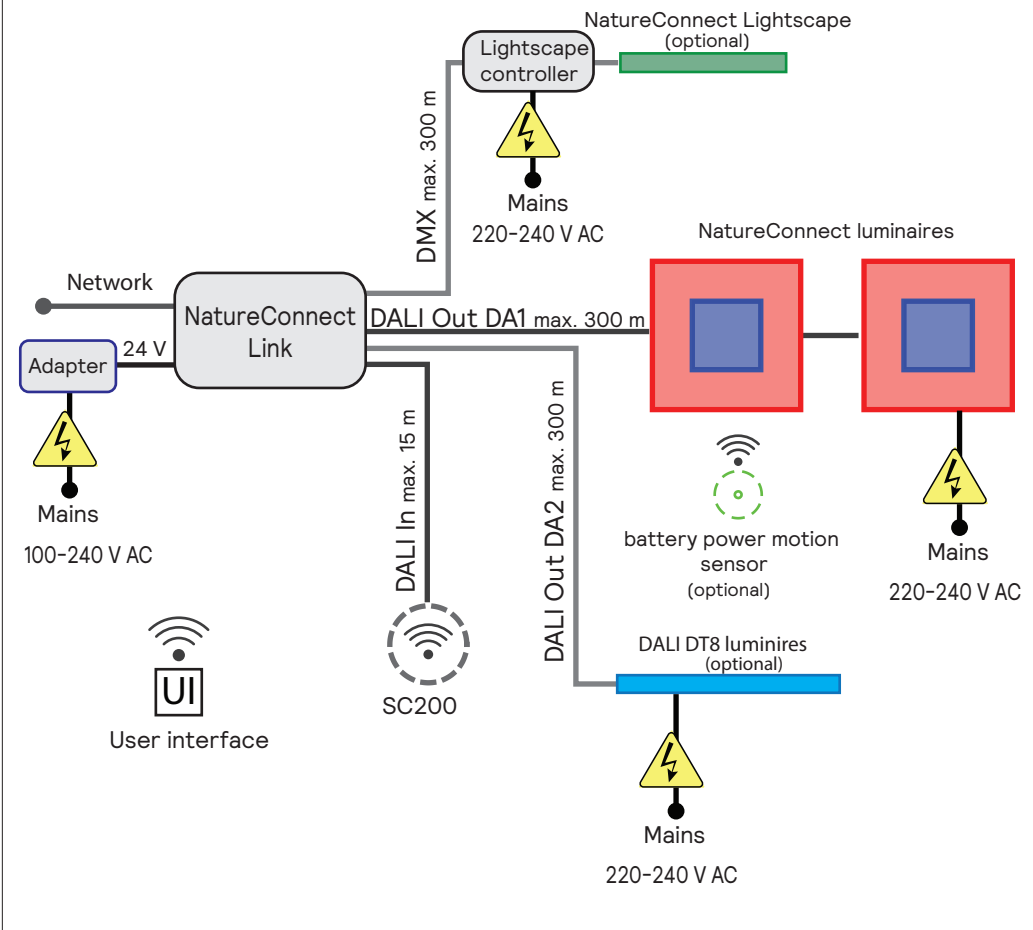

© 2025 Signify Holding.

All rights reserved. The information provided herein is subject to change, without notice. Signify does not give any representation or warranty as to the accuracy or completeness of the information included herein and shall not be liable for any action in reliance thereon. The information presented in this document is not intended as any commercial offer and does not form part of any quotation or contract, unless otherwise agreed by Signify.

All trademarks are owned by Signify Holding or their respective owners.







Use QR code to download Commissioning guide for Interact PRF and other information about NatureConnect.



<https://www.signify.com/global/innovation/natureconnect/download-assets>



