

# PHILIPS

Nissa Ultra Efficient  
9290046317



User manual  
Benutzerhandbuch  
Notice d'emploi  
Manual de usuario  
Manual do usuário  
Manuale d'uso  
Gebruiksaanwijzing

Incl.

**A**

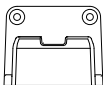
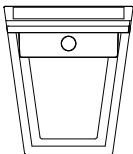

• x2    x1

x2

**B**



Excl.

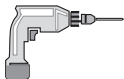

**B**



IP44

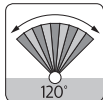
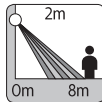
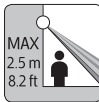

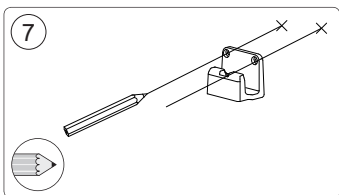
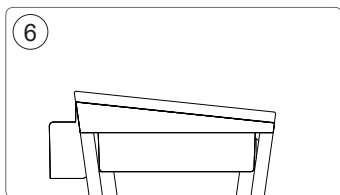
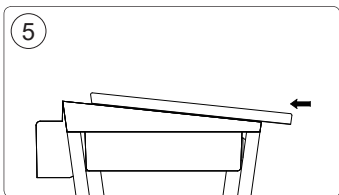
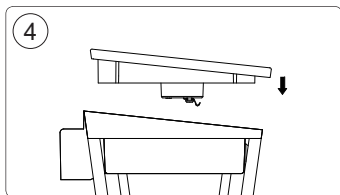
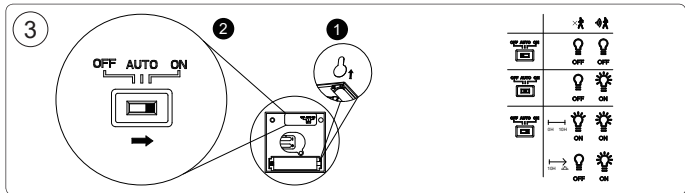
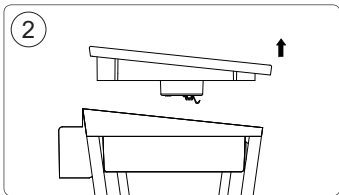
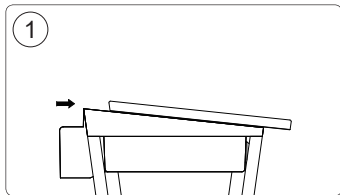

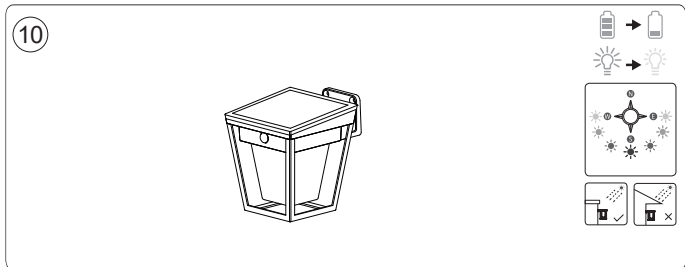
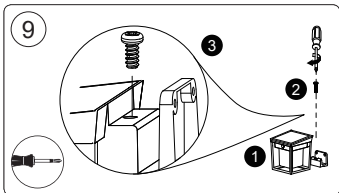
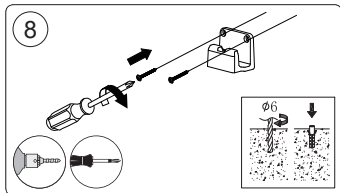

## Replace Battery

1

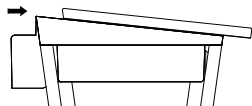

2

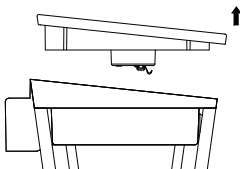

3

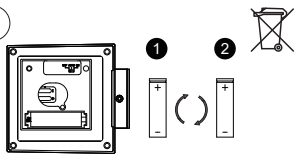

18650/3.6-3.7V Li-ion/MIN2600mAh

4

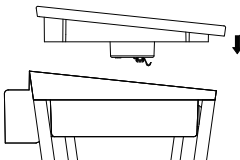

5

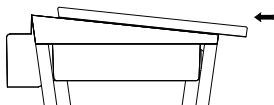

6

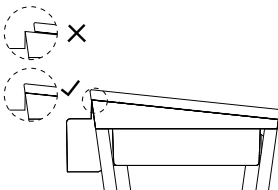



Signify Commercial UK Limited  
Unit 3, Guildford Business Park, Guildford,  
Surrey, GU2 8XG, UK

Signify  
I.B.R.S. / C.C.R.I. Numéro 10461  
5600 VB Eindhoven,  
the Netherlands  
☎00800-74454775

© 2024 Signify Holding

 signify

3241 662 11351

Philips and the Philips Shield Emblem  
are registered trademarks of Koninklijke  
Philips N.V. and are used under license

[www.philips.com/lighting](http://www.philips.com/lighting)