

No.	COMPONENT	QTY
1	Front Cover	1
2	Foam	1
3	Diffuser	1
4	Reflector Ring	1
5	Light Guide Plate	1
6	Reflector Paper	1
7	Screw ST2.9x8	4
8	LED Strip	1
9	Slicone Glue	1
10	Housing	1
11	Mounting Spring	2
12	Screw M2.5x3	2
13	Rear Cover	1
14	PSU	1

No.	SLR Description	Tools needed
a	Remove Mounting Spring 11	
b	Unscrew Screw M2.5x3 12	Cross Head Screw Driver
c	Rotate then remove Front Cover 1	
d	Remove Silicon Glue 9	Flat Head Screw Driver
e	Remove Diffuser 3	Flat Head Screw Driver
f	Remove Reflector Ring 4	
g	Remove Light Guide Plate 5	
h	Remove Reflector Paper 6	
i	Unscrew Screw ST2.9x8 7 then remove Rear Cover 13	Cross Head Screw Driver
j	Unplug LED Strip 8 from PSU 12	
H	Remove LED Strip 8 from Housing 9	

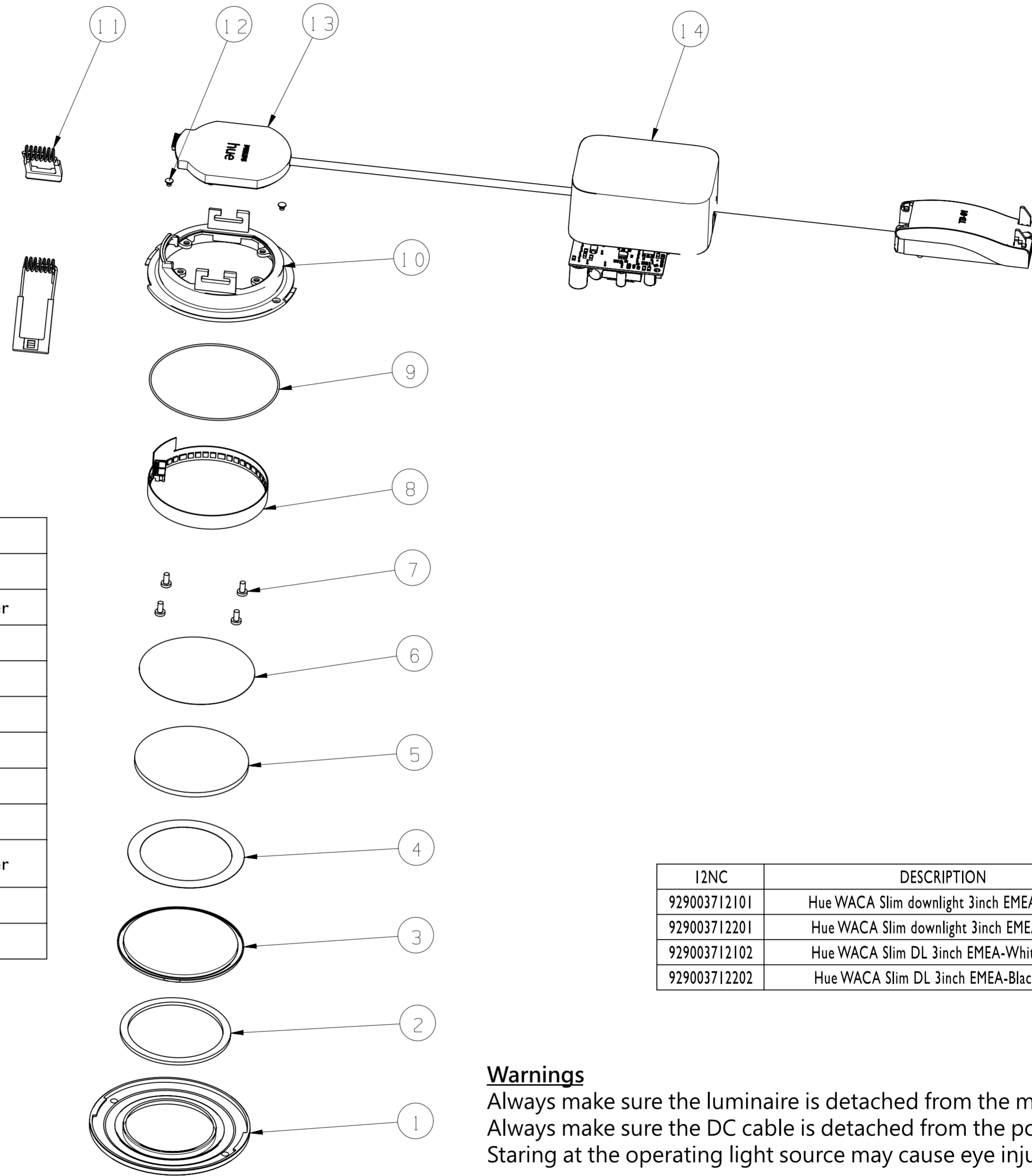

I2NC	DESCRIPTION
929003712101	Hue WACA Slim downlight 3inch EMEA-White
929003712201	Hue WACA Slim downlight 3inch EMEA-Black
929003712102	Hue WACA Slim DL 3inch EMEA-White Multi
929003712202	Hue WACA Slim DL 3inch EMEA-Black Multi

Warnings

Always make sure the luminaire is detached from the mains socket
Always make sure the DC cable is detached from the power supply
Staring at the operating light source may cause eye injury

STATUS	DESCRIPTION	DESIGN ID	2023-09-12
2021-08-24	Hue WACA Slim DL 3inch EMEA	DOC I2NC	
NAME Bruce Ji	LOCAL PART ID	SH. 5	SH.
CHECKED	DATE 2023-09-12		A2