

PHILIPS
hue

#	COMPONENT	QTY
1	FRAME	1
2	LED STRIP	2
3	DIFFUSER	1
4	LIGHT GUIDE PLATE	1
5	REFLECTIVE PAPER	1
6	EPE FOAM	1
7	BACK PLATE	1
8	INSTALLATION PLATE B	2
9	WAVY SHEETMETAL STOPER B	2
10	DECORATIVE BAR	4
11	SUSPENDED ROPE	2
12	NUT M4	2
13	M4X12 SCREW	4
14	INSTALLATION BOX	1
15	HUE CONTROL BOX BOTTOM HOUSING	1
16	INSTALLATION PLATE A	2
17	DRIVER	1
18	WAVY SHEETMETAL STOPER A	2
19	SELF TAPPING SCREW M3X6	20
20	HUE CONTROL PCBA	1
21	HUE CONTROL BOX TOP HOUSING	1
22	SCREW M3X4	4
23	CORNER PROTECTOR	4
24	L TYPE SHEET METAL PART	2
25	RIVET	10
26	SELF TAPPING SCREW M3X4	2
27	WIRE CONNECTION BOX	1

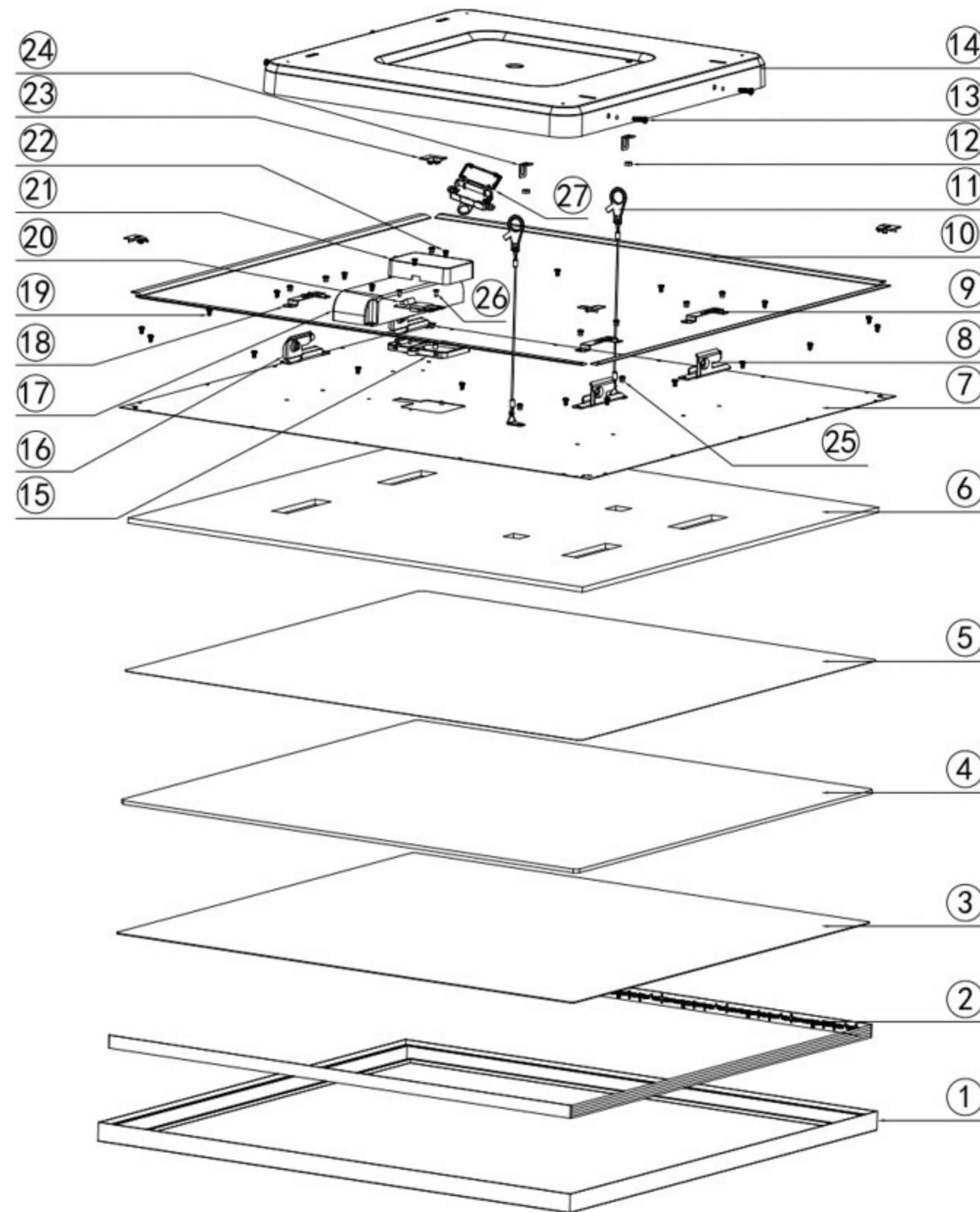

©ignify

#	SLR Description	Tools needed
a	REMOVE INSTALLATION BOX 14 BY UNSCREWING SCRWE 13	CROSS HEAD SCREW DRIVER
b	REMOVE CONNER PROTECTOR 23	FLAT HEAD SCREW DRIVER
c	REMOVE DECORATIVE BAR 10	
d	REMOVE SELF TAPPING SCREW M3X6 19	CROSS HEAD SCREW DRIVER
e	UNSCREW SCREW M3X4 22	CROSS HEAD SCREW DRIVER
f	REMOVE HUE CONTROL BOX TOP HOUSING 21	FLAT HEAD SCREW DRIVER
g	UNPLUG FLAT CABLE FROM HUE CONTROL PCBA 20	
h	UNSCREW SELF TAPPING SCREW M3X4 26	CROSS HEAD SCREW DRIVER
i	UNPLUG 24V POWER INPUT WIRE FROM HUE CONTROL PCBA 20	
j	REMOVE BACK PLATE 7	
k	REMOVE EPE FOAM 6	
l	REMOVE REFLECTIVE PAPER 5	
m	REMOVE LIGHT GUIDE PLATE 4	
n	REMOVE DIFFUSER 3	
o	REMOVE LED STRIP 2 FROM FRAME 1	

SKU	Color	Country
929003597601	Black frame	EU
929003597701	Black frame	EU

Warnings

Always make sure the luminaire is detached from the mains socket
Always make sure the DC cable is detached from the power supply
Staring at the operating light source may cause eye injury

FOR LIGHT SOURCE-LED STRIP REMOVAL PLEASE REFER TO DOCUMENT 442295215544_L2 Removal and Test Instruction Flex LED strip

STATUS	DESCRIPTION	DESIGN ID	DATE
2021-08-24	Aurette Hue Panel SQ Black 39W,panel extension 600X600mm Aurette Hue Panel REC Black 39W,panel extension 1200X300mm	DOC 12NC	2021-08-24
NAME Mg Lv	LOCAL PART ID	SH. 1	SH.
CHECKED	DATE 2023-02-01		A2