

Warnings

Always make sure the luminaire is detached from the mains socket
Always make sure the DC cable is detached from the power supply
Staring at the operating light source may cause eye injury

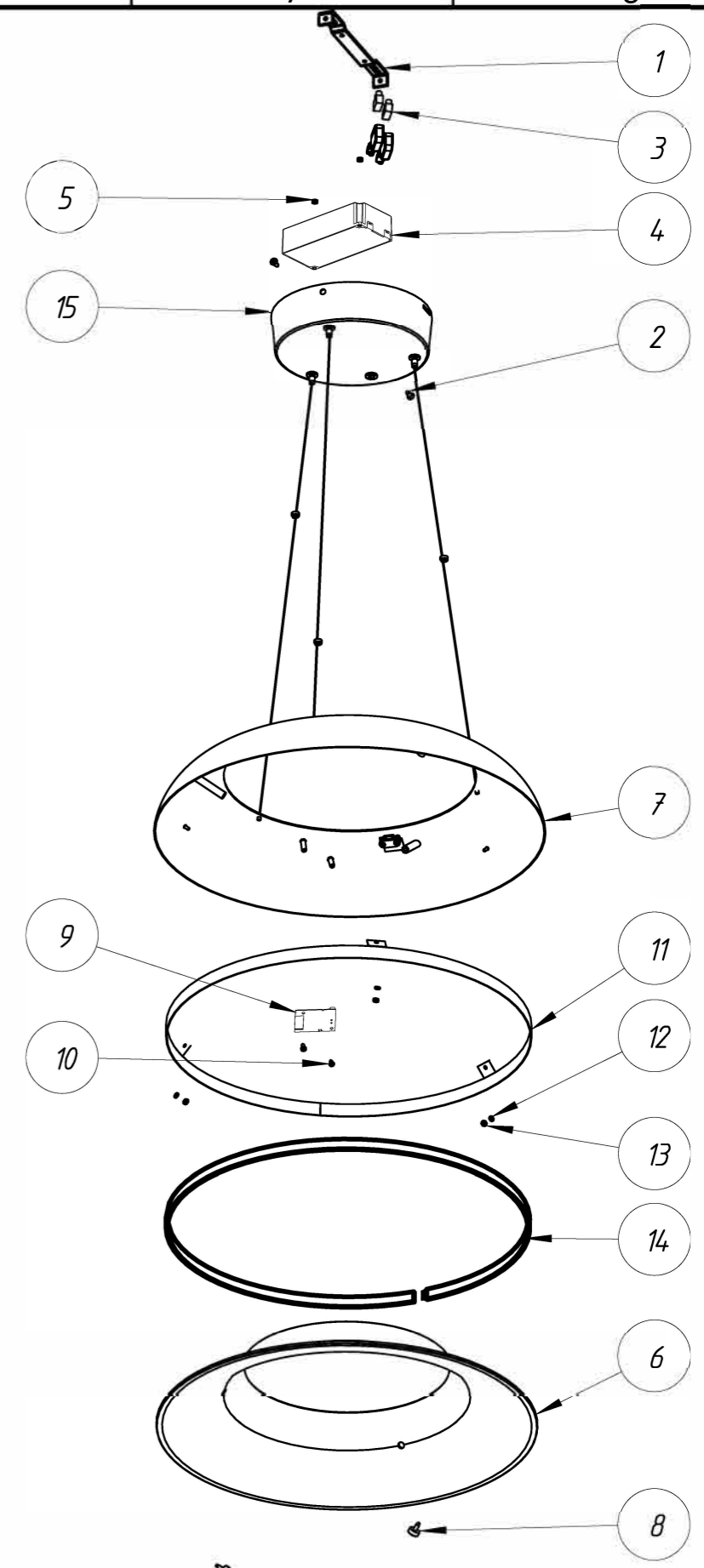

#	Disassemble/dismantle steps	Tools needed
a	Remove the bracket (1) from the base (15) by unscrewing screws (2)	CROSSHEAD SCREWDRIVER PZ
b	Remove the terminal blocks (3)	FLATHEAD SCREWDRIVER
c	Remove the CONTROL GEAR - PSU (5) from the base (15) by unscrewing nuts (5).	SOCKET WRENCH
d	Unclamp 2 close end connectors from the low voltage wires from CONTROL GEAR - PSU (4)	PINCER
e	Remove diffuser (6) by unscrewing screws (8)	-
f	Remove flat cable from the LIGHT SOURCE - LED STRIP [14] and LIGHT SOURCE - HUE CONNECT [9]	-
g	Remove low voltage wires of the cable of LIGHT SOURCE - HUE CONNECT (9)	FLATHEAD SCREWDRIVER OR WAGO TOOL #2065
h	Remove the LIGHT SOURCE - HUE CONNECT (9) from the cover (7) by unscrewing screws (10)	TORXHEAD SCREW DRIVER T10
i	Remove HEAT SINK (11) by unscrewing nuts (12).	SOCKET WRENCH
j	Remove light strip (14) acc. to instruction: 442295215544_L2 Removal and Test Instruction Flex LED strip	See instruction.

- A specific Wago tool #2065 can be ordered separately for wire insertion and release tool:

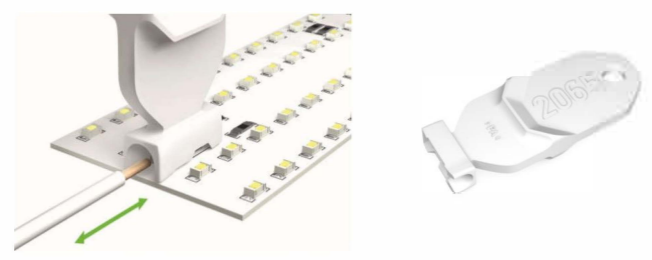

SKU	Color	Country
929003054801	WHITE	EU
929003054901	BLACK	EU

#	COMPONENT	QTY
1	BRACKET	1
2	SCREW	2
3	TERMINAL BLOCK	2
4	CONTROL GEAR - PSU	1
5	NUT	2
6	DIFFUSER	1
7	COVER	1
8	SCREW	3
9	LIGHT SOURCE - HUE CONNECT	1
10	SCREW	2
11	HEAT SINK	1
12	WASHER	3
13	NUT	3
14	LIGHT SOURCE - LED STRIP	1
15	BASE	1

STATUS	DESCRIPTION	DESIGN ID	01	2021-07-23
Amaze pendant Disassembly instruction				
NAME	He Go	LOCAL PART ID	SH.	2
CHECKED		DATE	2021-07-23	A3-L

