

DESCRIPTION

The Halo Surface LED Downlight (SLD) incorporates WaveStream™ technology to create an ultra-low profile surface mounting luminaire with the performance and look of a traditional downlight. SLD4 is designed for installation in many 3-1/2" and 4" round or octagon junction boxes. May also retrofit in 4" aperture IC and Non-IC recessed housings*. Dedicated LED wiring connector meets high-efficacy code requirement in recessed downlighting. Suitable for residential or commercial installations. Ideal for closets, storage areas, attics and basements. Compliant with NFPA® 70, NEC® Section 410.16 (A)(3) and 410.16 (C)(5).

SPECIFICATION FEATURES

CONSTRUCTION

- Die cast aluminum trim ring and die formed aluminum frame

OPTICS

- WaveStream™ technology provides uniform luminance from a low profile flat lens
- AccuAim™ optics provide directional control for the "cone-of-light" beam distribution of a traditional downlight
- Precision molded lens features high transmission polymer with UV stabilized protecting film

DESIGNER TRIMS

Accessories (sold separately) SLD designer trims are accessory rings that attach to the SLD for a permanent finish. Refer to SLD accessories specification sheet for details.

- White (Paintable)
- Satin Nickel
- Tuscan Bronze

ELECTRICAL JUNCTION BOX MOUNTING

- SLD may be used in compatible electrical junction boxes in direct contact with insulation including spray foam insulation
- Suitable for installation in many 3-1/2" and 4" octagon and round electrical junction boxes.
Note: Driver consumes 3 cubic inches of junction box.
- Installer must ensure compatibility of fit, wiring and proper mounting in the electrical junction box. This includes all applicable national and local electrical and building codes.
- Proprietary Slot-N-Lock quick installation system for junction box installation

- T-bracket with Slot-N-Lock mounting tabs included.

RECESSED HOUSING MOUNTING Friction Blade

- Pre-installed precision formed friction blades included
- Friction blade design allows the SLD to be installed in any position within the housing aperture (360 degrees)

* **Note:** Not for use in recessed housings in direct contact with spray foam insulation refer to NEMA LSD 57-2013

LED

- Trilateral linear LED assembly is integrated in trim perimeter.
- Color Temperature: 2700K, 3000K, 3500K, 4000K
- CRI options: 80 and 90*
 - 90 CRI can be used to comply with California Title 24 High Efficacy requirements. Certified to California Appliance Efficiency Database under JA8
- L70 at 50,000 hours projected in accordance with TM-21

WARRANTY
Cooper Lighting Solutions provides a five year limited warranty on the SLD LED

LED CHROMATICITY

- A tight chromaticity specification ensures LED color uniformity, sustainable Color Rendering Index (CRI) and Correlated Color Temperature (CCT) over the useful life of the LED
- LED chromaticity of 3 SDCM exceeds ENERGY STAR® color standards per ANSI C78.377-2008
- 90 CRI model features high color performance with R9 greater than 50

Catalog #		Type
Project		
Comments		Date
Prepared by		

- Every Halo LED is quality tested, measured, and serialized in a permanent record to register lumens, wattage, CRI and CCT.
- Halo LED serialized testing and measurement ensures color and lumen consistency on a per-unit basis, and validates long-term product consistency over time

ELECTRICAL CONNECTIONS

Junction Box

- Compatible with many 3-1/2" x 2" and 4" x 1-1/2" round and octagon boxes (2-1/8" deep boxes recommended)

- Supply Wire Adapter with LED quick connector included

Recessed Housings

- LED connector is compatible with Halo 4" H995 and H245 Series LED Housings
- LED Connector meets California Title-24 high-efficacy luminaire standard as a non-screw base
- The included E26 Edison screw-base adapter provides capability for retrofit*
- LED connector is a non-screwbase luminaire disconnect for tool-less installation

LED DRIVER

- Driver is a 120V input high efficiency, dimmable electronic power supply providing DC power to the LED array
- Driver features high power factor, low THD, and has integral thermal protection in the event of over temperature or internal failure.
- Driver is replaceable if it should be required



SLD4058xxWH
80CRI
2700K, 3000K, 3500K,
and 4000K

SLD4059xxWH
90CRI
2700K, 3000K, 3500K,
and 4000K

4" Surface LED Downlight

Suitable for ceiling or wall electrical junction boxes

Suitable for 4" recessed housing retrofit (IC, Non-IC & AIR-TITE™)

ENERGY DATA

	80 CRI	90 CRI
Lumens (4000K models)	800	710
Input Voltage	120V	120V
Frequency	50/60 Hz	50/60 Hz
Input Current	0.10 A	0.10 A
Input Power	12.2 W	12 W
Efficiency (4000K models)	66 lm/W	59 lm/W
THD	≤ 20%	
Power Factor	≥ 0.90	
T Ambient	-30 - +40°C	
Sound Rating	Class A	

NOMENCLATURE

SLD405830WH
405 = 4" SLD
8 = >80 CRI
30 = 3000K
WH = Matte White

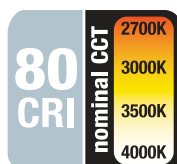

Refer to ENERGY STAR® Certified Products List.



Refer to ENERGY STAR® Qualified Products List. Can be used to comply with California Title 24 High Efficacy requirements. Certified to California Appliance Efficiency Database under JA8. Indoor LED nominal CCT of 4000K or less.

DIMMING

- Designed for continuous dimming capability to nominally 5% with many 120V Leading Edge (LE) and Trailing Edge (TE) phase control dimmers. Dimming to 5% is best assured using dimmers with low end trim adjustment. Consult dimmer manufacturer for compatibility and conditions of use. (Note some dimmers require a neutral in the wallbox.)

COMPLIANCE

- cULus Listed ceiling and wall
- cULus Damp Location listed ceiling and wall
- cULus Wet Location Listed, ceiling only (shower rated)
- Suitable for use in closets, compliant with NFPA® 70, NEC® Section 410.16 (A)(3) and 410.16 (C)(5)

- SLD may be used in compatible electrical junction boxes in direct contact with insulation including spray foam insulation
- May be installed in IC recessed housings in direct contact with insulation (Not for use in recessed housings in direct contact with spray foam insulation. Refer to NEMA LSD 57-2013)
- UL Classified when used in retrofit with listed housings (See Housing Compatibility)
- EMI/RFI: meets FCC 47CFR Part 15 Class B limits, and is suitable for use in residential and commercial installations
- Airtight certified per ASTM E283 (not exceeding 2.0 CFM under 57 Pascals pressure difference)
- 90 CRI: Can be used to comply with California Title 24 High Efficacy requirements.
- 80 CRI: Can be used to comply with California Title 24 Non-Residential Lighting Controls requirements as a LED luminaire.
- Can be used for International Energy Conservation Code (IECC)
- ENERGY STAR® Certified luminaire - consult ENERGY STAR® Certified Product List
- Contains no mercury or lead and RoHS compliant.
- Photometric testing in accordance with IES LM-79
- Lumen maintenance projections in accordance with IES LM-80 and TM-21



SLD4058xxWH

80CRI
2700K, 3000K, 3500K,
and 4000K

SLD4059xxWH

90CRI
2700K, 3000K, 3500K,
and 4000K

**4" Surface LED
Downlight**

**Suitable for
ceiling or wall
electrical junction boxes**

**Suitable for
4" recessed
housing retrofit
(IC, Non-IC & AIR-TITE™)**

DIMENSIONS

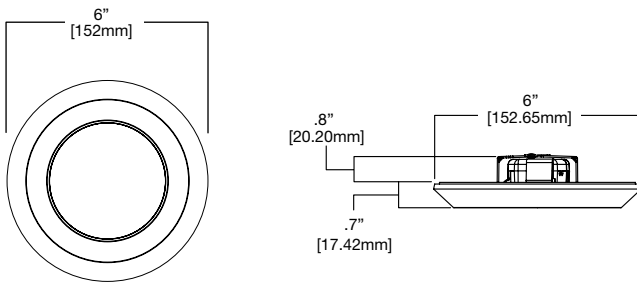

ORDERING INFORMATION

SAMPLE NUMBER: SLD405927WH SLD4TRMSN

Junction Box Installation: Order junction box separately, as supplied by others, to complete installation.

Recessed Installation: Order Halo recessed housing separately to complete installation.

Models	Color Rendering Index	Color Temperature (CCT)	Finish	Accessories
SLD405= 4" Surface LED Downlight, 120V <u>California non-E26 Models</u> SLD405927WH-CA SLD405930WH-CA SSLD405935WH-CA SSLD405940WH-CA	8= 80 CRI 9= 90 CRI	27= 2700K 30= 3000K 35= 3500K 40= 4000K	WH= White	<u>Designer Trims</u> Fit over the SLD4 for a designer finish SLD4TRMSN= 4" SLD Satin Nickel SLD4TRMTBZ= 4" SLD Tuscan Bronze SLD4TRMWH= 4" SLD White (paintable) <u>J-Box Spacer Extension Ring</u> Add 15/16" depth when SLD driver cannot fit into installed junction box SLD4EXT= 4" Surface LED J-Box Extender, 7.75" O.D. <u>RAD Adapters</u> When junction box is mounted flat on a ceiling or beam surface (not recessed in ceiling) SLD4RAD= 4" SLD Round Surface J-Box Adapter, 6.15" O.D. (For 4-inch round or octagon junction boxes) <u>Spare Parts</u> SLD4ACCKIT= 4" Accessory Parts Replacement Kit (Screwbase adapter, torsion springs, friction blades) SLD4BRKT= 4" Junction Box Bracket & Screws Refer to SLD Accessories specification sheet for further information.

HOUSING COMPATIBILITY

The SLD4 is UL Listed in Halo recessed housings, and is UL Classified for use with any 4 inch diameter recessed housing constructed of steel or aluminum with an internal volume that exceeds 62.3 in³ in addition to those noted below:

Compatible Halo LED Housings with LED luminaire connector (high-efficacy compliant)		
HALO LED	Recessed Can Size	Catalog Number
		4"
Compatible Halo Incandescent E26 Screwbase Housings		
HALO	Recessed Can Size	Catalog Number
	4"	H99ICAT, H99TAT, H99RTAT, E4ICATSB, E4TATSB, E4RTATSB

COMPATIBLE WITH COOPER LIGHTING SOLUTIONS' CROUSE-HINDS JUNCTION BOXES

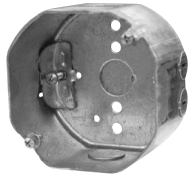

TP316
for non-metallic cable
4" x 4" x 2-1/8"
(102mm x 102mm x 54mm)



TP317
for metal clad cable
4" x 4" x 2-1/8"
(102mm x 102mm x 54mm)

- TP316 - for non-metallic cable
- TP317 - for metal clad cable
- UL Listed
- Refer to www.crouse-hinds.com

COMPATIBLE WITH MANY OTHER JUNCTION BOXES*



4" octagon light fixture/fan steel box
4" x 4" x 2-1/8"
(102mm x 102mm x 54mm)



4" octagon steel box
4" x 4" x 1-1/2"
(102mm x 102mm x 38mm)



4" round new work non-metallic box with hanger bar assembly
4" diameter x 2-3/16" (102mm x 56mm)



4" round new work non-metallic light fixture/fan box
4" diameter x 2-3/16"
(102mm x 56mm)



3-1/2" round new work non-metallic ceiling box
3-1/2" diameter x 2-3/4"
(89mm x 70mm)



3-1/2" round old work non-metallic box
4-1/4" O.D. flange, 3-1/2" I.D. x 2-5/8"
(108mm O.D., 89mm I.D. x 67mm)



4" round surface mount box
4" diameter x 1-1/2"
(102mm x 38mm)
Requires SLD4RAD adapter

*This is a representative list of compatible junction boxes only. Information contained in this literature about other manufacturers' products is from published information made available by the manufacturer and is deemed to be reliable, but has not been verified. Cooper Lighting Solutions makes no specific recommendation on product selection and there are no warranties of performance or compatibility implied. Installer must determine that site conditions are suitable to allow proper installation of the SLD mounting bracket in the box.

PRODUCT DATA

Cat No.	CRI	CCT	Lumens	Power (W)	LPW
SLD405827WH	81	2700	720	12.2	59
SLD405830WH	81	3000	750	12.2	61
SLD405835WH	81	3500	780	12.2	64
SLD405840WH	81	4000	800	12.2	66
SLD405927WH	92	2700	650	12	54
SLD405930WH	92	3000	670	12	56
SLD405935WH	92	3500	690	12	58
SLD405940WH	92	4000	710	12	59

Performance values are presented as typical for the model(s) indicated. Field results may vary.

LIGHTING FACTS®

SLD405827WH - 80 CRI

LED lighting facts®
A Program of the U.S. DOE

Light Output (Lumens) 720
Watts 12.2
Lumens per Watt (Efficacy) 59.02

Color Accuracy
Color Rendering Index (CRI) 81

Light Color
Correlated Color Temperature (CCT) 2700 (Warm White)

2700K 3000K Bright White 4500K Daylight 6500K

Registration Number: F4QJ-78R3UK (4/17/2015)
Model Number: SLD405827WH
Type: Luminaire - Downlight

SLD405830WH - 80 CRI

LED lighting facts®
A Program of the U.S. DOE

Light Output (Lumens) 750
Watts 12.2
Lumens per Watt (Efficacy) 61.48

Color Accuracy
Color Rendering Index (CRI) 81

Light Color
Correlated Color Temperature (CCT) 3000 (Bright White)

2700K 3000K Bright White 4500K Daylight 6500K

Registration Number: F4QJ-C7D2C3 (5/7/2015)
Model Number: SLD405830WH (Upgrade 942015)
Type: Luminaire - Downlight

SLD405835WH - 80 CRI

LED lighting facts®
A Program of the U.S. DOE

Light Output (Lumens) 780
Watts 12.2
Lumens per Watt (Efficacy) 63.93

Color Accuracy
Color Rendering Index (CRI) 81

Light Color
Correlated Color Temperature (CCT) 3500 (Bright White)

2700K 3000K Bright White 4500K Daylight 6500K

Registration Number: F4QJ-B618FN (4/17/2015)
Model Number: SLD405835WH
Type: Luminaire - Downlight

SLD405840WH - 80 CRI

LED lighting facts®
A Program of the U.S. DOE

Light Output (Lumens) 800
Watts 12.2
Lumens per Watt (Efficacy) 65.57

Color Accuracy
Color Rendering Index (CRI) 81

Light Color
Correlated Color Temperature (CCT) 4000 (Bright White)

2700K 3000K Bright White 4500K Daylight 6500K

Registration Number: F4QJ-M8ZDPK (4/17/2015)
Model Number: SLD405840WH
Type: Luminaire - Downlight

SLD405927WH - 90 CRI

LED lighting facts®
A Program of the U.S. DOE

Light Output (Lumens) 650
Watts 12
Lumens per Watt (Efficacy) 54.17

Color Accuracy
Color Rendering Index (CRI) 92

Light Color
Correlated Color Temperature (CCT) 2700 (Warm White)

2700K 3000K Bright White 4500K Daylight 6500K

Registration Number: F4QJ-Q8MB8G (4/17/2015)
Model Number: SLD405927WH
Type: Luminaire - Downlight

SLD405930WH - 90 CRI

LED lighting facts®
A Program of the U.S. DOE

Light Output (Lumens) 670
Watts 12
Lumens per Watt (Efficacy) 55.83

Color Accuracy
Color Rendering Index (CRI) 92

Light Color
Correlated Color Temperature (CCT) 3000 (Bright White)

2700K 3000K Bright White 4500K Daylight 6500K

Registration Number: F4QJ-14JH81 (5/7/2015)
Model Number: SLD405930WH (Upgrade 042015)
Type: Luminaire - Downlight

SLD405935WH - 90 CRI

LED lighting facts®
A Program of the U.S. DOE

Light Output (Lumens) 690
Watts 12
Lumens per Watt (Efficacy) 57.5

Color Accuracy
Color Rendering Index (CRI) 92

Light Color
Correlated Color Temperature (CCT) 3500 (Bright White)

2700K 3000K Bright White 4500K Daylight 6500K

Registration Number: F4QJ-2DFUT (4/17/2015)
Model Number: SLD405935WH
Type: Luminaire - Downlight

SLD405940WH - 90 CRI

LED lighting facts®
A Program of the U.S. DOE

Light Output (Lumens) 710
Watts 12
Lumens per Watt (Efficacy) 59.17

Color Accuracy
Color Rendering Index (CRI) 92

Light Color
Correlated Color Temperature (CCT) 4000 (Bright White)

2700K 3000K Bright White 4500K Daylight 6500K

Registration Number: F4QJ-1K230B (4/17/2015)
Model Number: SLD405940WH
Type: Luminaire - Downlight