

**DESCRIPTION**

A family of Gimbal Ring lampholders designed for PAR30 or PAR38 lamps. Lampholders are available in Satin White or Matte Black finishes. Lazer lampholders are compatible with all Halo Power-Trac systems.

Catalog #	Type
Project	
Comments	
Prepared by	Date

**SPECIFICATION FEATURES**

**A...Electrical Quick Lock Adapter**

Lexan polycarbonate casing. Attaches electrically and mechanically anywhere along track. Visual polarity line assures proper grounding. Two position conductor allows use in single circuit and either circuit of two circuit track.

**B...Yoke**

Matching finish yoke allows lampholder to rotate 358° and adjust vertically from 0° to 90°.

**C...Gimbal Ring**

Die formed gimbal ring contains lamp retention springs, provide lamp regress for optimum lamp position, provides uniform appearance between lamp types.

**Listings**

UL/CSA listed for use with Halo and Lazer-by-Halo track and track systems

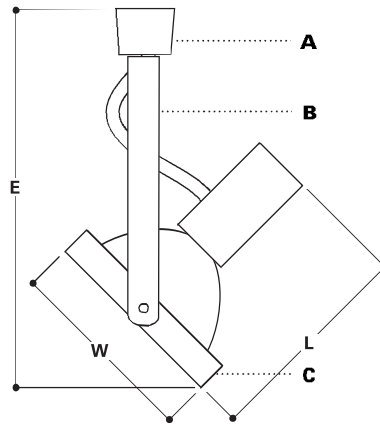

**LZR330**



**LZR338**

**LINE VOLTAGE  
GIMBAL RING  
LAMPHOLDERS**

Lazer by Halo

**ORDERING INFORMATION**

SAMPLE NUMBER: LZR330P

Lampholders	Finishes
LZR330 LZR338	P=Satin White with Black Baffle MB=Satin Black with Black Baffle



**LZR330**

For use with:  
75W PAR30  
(Short neck lamp only)  
W=4" [102mm]  
L =4 1/4" [108mm]  
E =7 15/16" [202mm]

**LZR338**

For use with:  
150W PAR38  
W=5" [111mm]  
L=6 1/8" [156mm]  
E =10 1/4" [260mm]

ADV990373

9/04

TAB: Lazer Lampholders and Track  
Sheet 4

Note: Specifications and Dimensions subject to change without notice.

Visit our web site at [www.cooperlighting.com](http://www.cooperlighting.com)