

PHILIPS

hue personal wireless lighting

Festavia String lights | luz string 500 LEDs

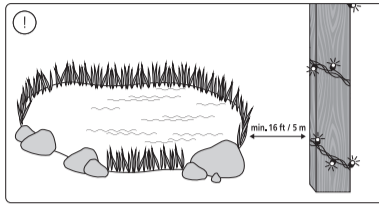
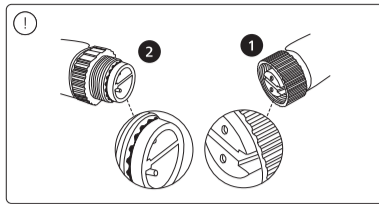
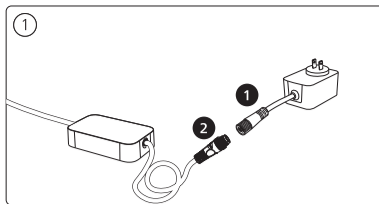
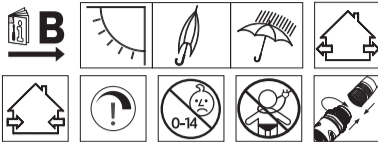
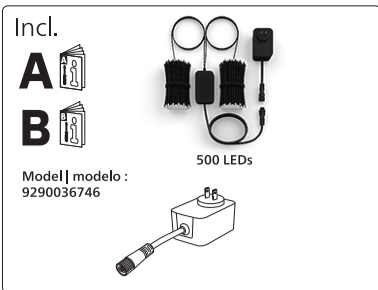

Signify North America Corporation 400 Crossing Blvd, Suite 600 Bridgewater, NJ 08807, USA

Questions or Comments: 1-800-555-0050

Importado y/o distribuido en México por: Signify Mexico S.A. De C.V. Av. La Palma No. 6, La Herradura, Huixquilucan, Edo de México, C.P. 52784, México RFC PME-620620-E84

Centro de contacto: 800-508-9000

www.philips-hue.com

© 2024 Signify Holding All rights reserved

442296205522

Last update: 01/2024



User manual Manual do usuário

2

3

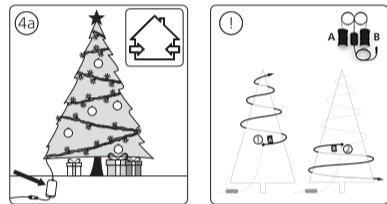
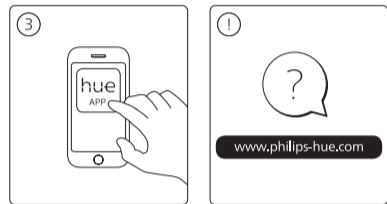
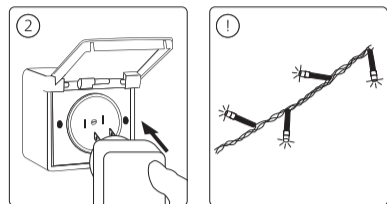

4

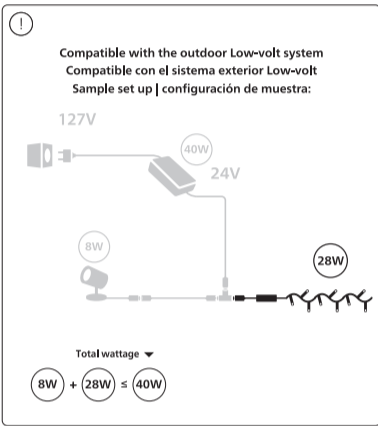
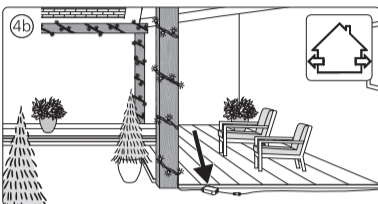

5

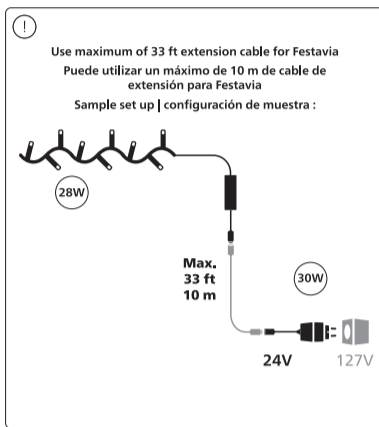

6

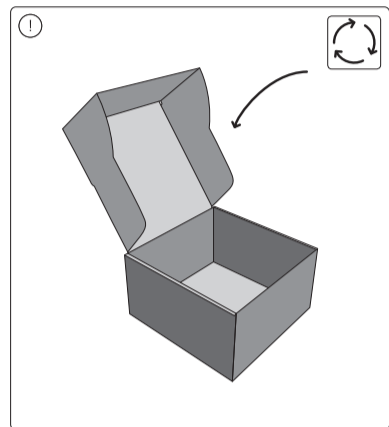
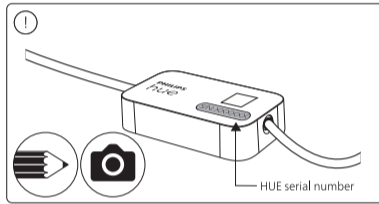

7

IMPORTANT SAFETY INSTRUCTIONS - READ AND FOLLOW ALL SAFETY INSTRUCTIONS

Do not use seasonal products outdoors unless marked suitable for indoor and outdoor use. When products are used in outdoor applications, connect the product to a Ground Fault Circuit Interrupting (GFCI) outlet. If one is not provided, contact a qualified electrician for proper installation. This seasonal use product is not intended for permanent installation or use. Do not mount or place near gas or electric heaters, fireplace, candles

or other similar sources of heat. Do not secure the wiring of the product with staples or nails, or place on sharp hooks or nails. Do not let lamps rest on the supply cord or on any wire. Unplug the product when leaving the house, when retiring for the night, or if left unattended. This is an electric product-not a toy! To avoid risk of fire, burns, personal injury and electric shock it should not be played with or placed where small children can reach it. Do not use this product for other than its intended use. Do not hang ornaments or other objects from cord, wire, or light string. Do not close doors or windows on the product or extension cords as this may damage the wire insulation. Do not cover the product with cloth, paper, or any material not part of the product when in use. Do not mount power supply permanently to a building.

Read and follow all instructions that are on the product or provided with the product.

Use only with Philips Hue Low-volt extension cable. Reference the National Electrical Code, ANSI/NFPA 70, specifically for the installation of wiring and clearance from power and lighting conductors. Installation work and electrical wiring must be done by qualified person(s) in accordance with all applicable codes and standards, including fire-rated construction. Do not install or use within 16 feet of a pool. Do not use in a bathroom.

SAVE THESE INSTRUCTIONS FOR FUTURE REFERENCE

Risk of Electric Shock. When used outdoors, install only to a covered Class A GFCI protected receptacle that is weatherproof with the power unit connected to the receptacle. If one is not provided, contact a qualified electrician for proper installation. Ensure that the power unit and cord do not interfere with completely closing the receptacle cover. Not for use with receptacles that are weatherproof only when the receptacle is covered (attachment plug cap not inserted and receptacle cover closed). The lamps are not replaceable. To reduce the risk of fire or electric shock, do not try to replace the lamps or modify the string.

This is a series connected lighting string. To reduce the risk of fire or electric shock, use only the power supply model that was provided with this product. To reduce the risk of fire and electric shock: a) Do not install on trees having needles, leaves or branch coverings of metal or materials which look like metal, and b) Do not mount or support strings in a manner that can cut or damage wire insulation. Do not submerge luminaire or power supply in water. This luminaire and power supply unit is intended for installation in accordance with the National Electrical Code and local code specifications. Failure to adhere to these codes and instructions may result in serious injury and/or damage to the PSU and void the warranty. These instructions do not purport to cover all details or variations in equipment, nor to provide for every possible contingency related to installation, operation, maintenance, or mounting

situation. Should specific problems occur that are not addressed by these instructions, contact your Sales Representative or distributor for assistance.

Use and Care Instructions

When the product is placed on a live tree, the tree should be well maintained and fresh. Do not place on live trees in which the needles are brown or break off easily. Keep the tree holder filled with water. If the product is placed on a tree, the tree should be well secured and stable. Before using or reusing, inspect product carefully. Discard any products that have cut, damaged, or frayed wire insulation or cords, cracks in the lampholders or enclosures, loose connections, or exposed copper wire.

When storing the product, carefully remove the product from wherever it is placed, including trees, branches, or bushes, to avoid any undue strain or stress on the product conductors, connections, and wires. When not in use, store neatly in a cool, dry location protected from sunlight.

Información para el mercado Mexicano Leer y seguir todas las instrucciones de seguridad

Este artículo decorativo no se destina para utilizarse por personas (incluyendo niños) cuyas capacidades físicas, sensoriales o mentales sean

diferentes o estén reducidas, o carezcan de experiencia o conocimiento, a menos que dichas personas reciban una supervisión. Vigile a los niños para que no usen este artículo como un juguete. Para reducir el riesgo de incendio y choque eléctrico: Desconectar de la fuente de alimentación el artículo decorativo antes de realizar cualquier actividad de mantenimiento o limpieza. No instalar ni colocar cerca de instalaciones de gas o calentadores eléctricos, chimeneas, velas o de otras fuentes similares del calor. Desconectar el producto al salir de la casa, al retirarse a dormir, o si se deja sin atención. No colgar adornos u otros objetos al cordón, cable o serie de luces. No cubrir el artículo decorativo con tela, papel o cualquier material que no sea parte del producto cuando está en uso. No instalar las series de manera que se pueda cortar o dañar el aislamiento del cable.