



by Signify

Recessed

Shine

Standalone Installation Instructions

2'x2', 2'x4', 1'x4', 600x600mm,  
600x1200mm, 20"x2' & 20"x4'



Power Feed

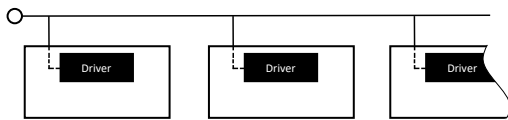

Every fixture contains its own driver and receives a direct power feed.

**1 Bend mounting tab**

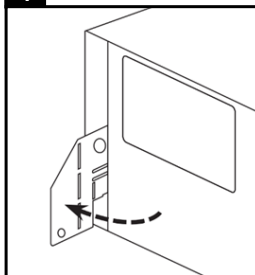

Bend out mounting tab 90 degrees on each corner.

**2 Adjust height of tab**

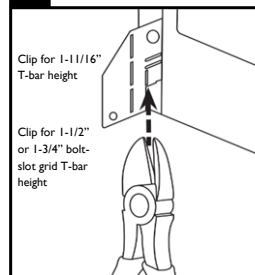

Use side cutters to adjust each tab to height of T-grid.

**3 Lay fixture into T-grid**

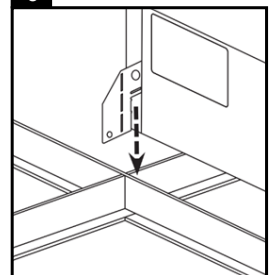

Lay fixture into T-grid.

**4 Bend tabs flush**

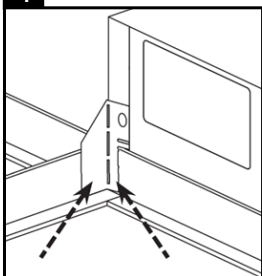

Bend tabs flush against T-grid in order to clear for ceiling tile.

**5 Fasten fixture to T-grid**

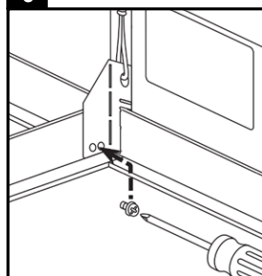

Use a #8x1/4" sheet metal screw to fasten fixture to T-grid and use a hanger wire to tie off appropriately in accordance with the local building codes (screws and hanger wires supplied by others).

**6 Electrical connections**

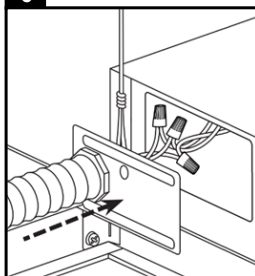

Make all electrical connections to the fixture.

**Note: For flex whip option, see Step 6a.**

**6a Flex whip (optional)**

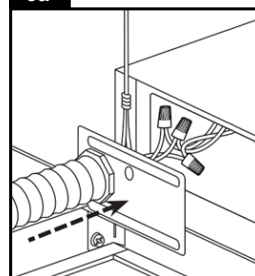

Optional Flex whip is prewired inside fixture. Remove packaging and insert snap-in fitting into wiring cover. Complete electrical connections at other end of whip in accordance with local building codes.

**7 Filler panels (20"x4' only)**

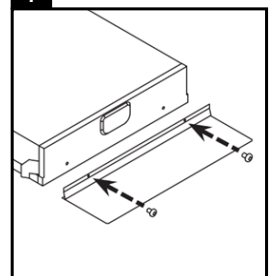

Attach filler panels to ends of housing using two supplied screws shown above.

**! ATTENTION: Install in accordance with national and local building and electrical codes.**

Page 1



©2019 Signify Holding. All rights reserved. This document may be subject to change. No representation or warranty as to the accuracy or completeness of the information included herein is given and any liability for any action in reliance thereon is disclaimed. All trademarks are owned by Signify Holding or their respective owners.

Signify North America Corporation  
200 Franklin Square Drive,  
Somerset, NJ 08873  
Telephone 855-486-2216

Signify Canada Ltd.  
281 Hillmount Road,  
Markham, ON, Canada L6C 2S3  
Telephone 800-668-9008