



# Setting the standard in Surface-mounted LED Downlight

## GreenSpace Surface-mounted

Philips GreenSpace Surface-mounted LED Downlight delivers a superior LED alternative that's up to 66% more energy efficient than the conventional downlight retrofits. Blending seamlessly into its environment, GreenSpace Surface-mounted LED Downlight mimics the form of conventional recessed downlights minus the associated high energy and maintenance costs. Philips GreenSpace Surface-mounted LED Downlight is also ideal for all commercial lighting applications as well as public indoor space where there is limited space in the ceiling.

### Benefits

- Lumen output: Different lumens in different sizes and mounting heights with options of 1000lm, 2000lm, 3800lm & 6600lm.
- Superior light performance: Colors rendered accurately(CRI>80) and high system efficacy(100lm/w)
- Varieties: IP20, IP65 version with choice of different lumen output, and option of black housing through tailor-made
- Long lifetime: 50,000 hour lifetime ensures more savings in the long run

### Features

- System efficacy: 100lm/W, energy saving up to 66% vs conventional downlights
- Reliable performance: Lifetime 50,000hours (L70B50@Ta25°C)
- Excellent light quality - CRI>=80 @3000K,4000K and 6500K
- Integral lightweight design – Installation cost is significantly reduced

## GreenSpace Surface-mounted

### Application

- Shopping mall
- Station concourse
- Canopy
- Airport public area
- Stadium public area

### Specifications

|   |  |
|---|--|
| Mounting type                                   | surface mounted  |
| Operating Temperature range                     | -20°C to +40°C   |
| Light Source                                    | LED module   |
| Mains Voltage                                   | 220-240V AC / 50-60Hz  |
| Dimming   | PSU: non-dimmable  |
| Material  | Housing: Die-cast Aluminum                                       |
| Main color of the luminaire                     | White<br>Black (ETO available )                                  |
| Lumen maintenance at median useful life 50.000h | L70  |
| Luminous flux                                   | LED10: 1000lm<br>LED20: 2000lm<br>LED40: 3800lm<br>LED70: 6600lm |

|                                    |  |
|------------------------------------|--|
| Power consumption                  | 10W, 20W, 38W, 66W   |
| Luminaire efficacy                 | 100lm/W @840   |
| Correlated color temperature - CCT | 3000K, 4000K, 6500K  |
| Color Rendering index - CRI        | 80   |
| Beam angle                         | LED10 & LED20: 90°<br>LED40 & LED70: 60°                                 |
| Protection Class IEC61140          | Class I  |
| Ingress protection                 | IP20 & IP65 for LED40 & LED70 only                                       |
| Overall diameter                   | LED10/LED20: 160mm<br>LED70: 200mm<br>LED40: 160mm (IP20) & 200MM (IP65) |
| Installation                       | Surface Mount  |

### Dimensional drawing

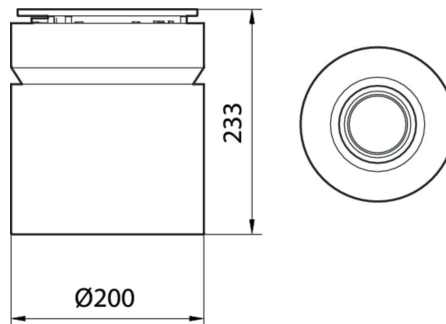
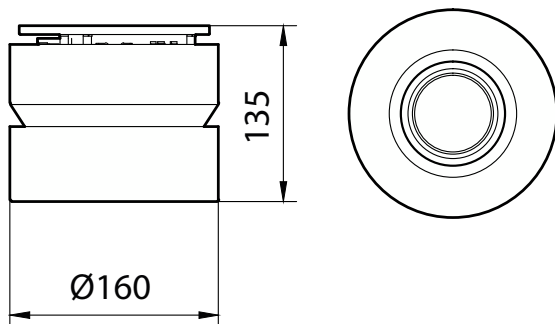

# GreenSpace Surface-mounted

## General Information

|                          |                                  |
|--------------------------|----------------------------------|
| CE mark                  | CE mark                          |
| Driver included          | Yes                              |
| ENEC mark                | -                                |
| Flammability mark        | -                                |
| Glow-wire test           | Temperature 750 °C, duration 5 s |
| Light source replaceable | No                               |
| Number of gear units     | 1 unit                           |
| Service tag              | Yes                              |

## Light Technical

|                                    |                   |
|------------------------------------|-------------------|
| Beam angle of light source         | - degree(s)       |
| Correlated Color Temperature (Nom) | 4000 K            |
| Optical cover type                 | Reflector         |
| Color rendering index (CRI)        | >80               |
| Luminous Efficacy (rated) (Nom)    | 105 lm/W          |
| Optic type                         | High-gloss mirror |

## Operating and Electrical

|                |              |
|----------------|--------------|
| Input Voltage  | 220 to 240 V |
| Line Frequency | 50 or 60 Hz  |

## Temperature

|                           |               |
|---------------------------|---------------|
| Ambient temperature range | -20 to +40 °C |
|---------------------------|---------------|

## Controls and Dimming

|          |    |
|----------|----|
| Dimmable | No |
|----------|----|

## Mechanical and Housing

|               |       |
|---------------|-------|
| Housing Color | White |
|---------------|-------|

## Approval and Application

|                              |                |
|------------------------------|----------------|
| Protection class IEC         | Safety class I |
| Mech. impact protection code | IK02           |

## Initial Performance (IEC Compliant)

|                         |                         |
|-------------------------|-------------------------|
| Initial chromaticity    | (0.38, 0.38) SDCM<br><5 |
| Luminous flux tolerance | +/-10%                  |

## Over Time Performance (IEC Compliant)

|                               |                |
|-------------------------------|----------------|
| Driver failure rate at 5000 h | 1.00 %         |
| Median useful life L80B50     | 40,000 hour(s) |
| Median useful life L90B50     | 20,000 hour(s) |

## Application Conditions

|                               |    |
|-------------------------------|----|
| Suitable for random switching | No |
|-------------------------------|----|

## Light Technical

| Order Code   | Full Product Name             | Luminous Flux |
|--------------|-------------------------------|---------------|
| 911401847599 | SM293C LED20/840 PSU WH GM    | 2,000 lm      |
| 911401847999 | SM294C LED40/840 PSU WP WH GM | 3,800 lm      |

## Operating and Electrical

| Order Code   | Full Product Name          | Power Consumption |
|--------------|----------------------------|-------------------|
| 911401847599 | SM293C LED20/840 PSU WH GM | 19 W              |

| Order Code   | Full Product Name             | Power Consumption |
|--------------|-------------------------------|-------------------|
| 911401847999 | SM294C LED40/840 PSU WP WH GM | 36 W              |

# GreenSpace Surface-mounted

## Approval and Application

| Order Code   | Full Product Name          | Ingress protection code |
|--------------|----------------------------|-------------------------|
| 911401847599 | SM293C LED20/840 PSU WH GM | IP20                    |

| Order Code   | Full Product Name             | Ingress protection code |
|--------------|-------------------------------|-------------------------|
| 911401847999 | SM294C LED40/840 PSU WP WH GM | IP65                    |

