

System Overview

These instructions review how to install Chopstick LED suspended fixtures. Chopstick 4ft, 6ft, & 8ft modules can be installed as individual standalone units, or they can be joined together to create continuous rows. The graphic below shows the components required to install a typical row of Chopstick LED suspended fixtures.

IMPORTANT: Read all instructions including fixture wiring AND mechanical details **before** beginning installation.

Chopstick joint kit(s)*

- A/C mounting bracket
- Break apart joiner aligner
- #8-B x 1/4" screw
- #10-24 x 9/16" bolt (x2)
- #10-24 nut (x2)
- Gasket

*Note: 1 kit required for each in-row joint.

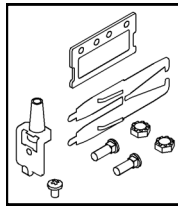

Chopstick end kit(s)*

- Endcap
- A/C mounting bracket
- #8-B x 1/4" screw
- 1 1/32" self-threading nuts (x2)

*Note: 2 kits required for row (one for each end).

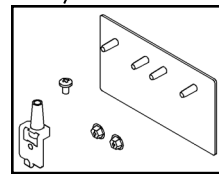

Module Lengths

Chopstick LED suspended systems come in 4ft, 6ft, & 8ft modules. Overall module lengths are shown here. Module lengths do not include endcaps.

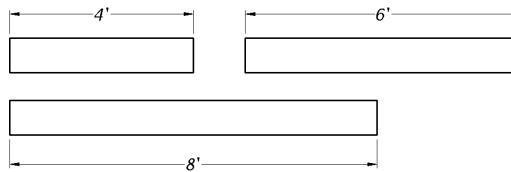

Endcaps

Add two endcaps to the length of each row.

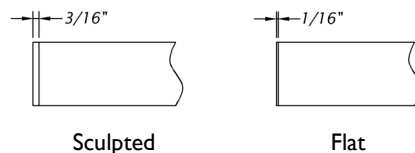

Mount Spacing

For on-grid T-bar ceiling installations, mounts attach directly to the Tee. For non-accessible ceilings and off-grid T-bar installations, the graphic below indicates mount spacing for typical row lengths. Mounting options are also available for a variety of other ceiling types.

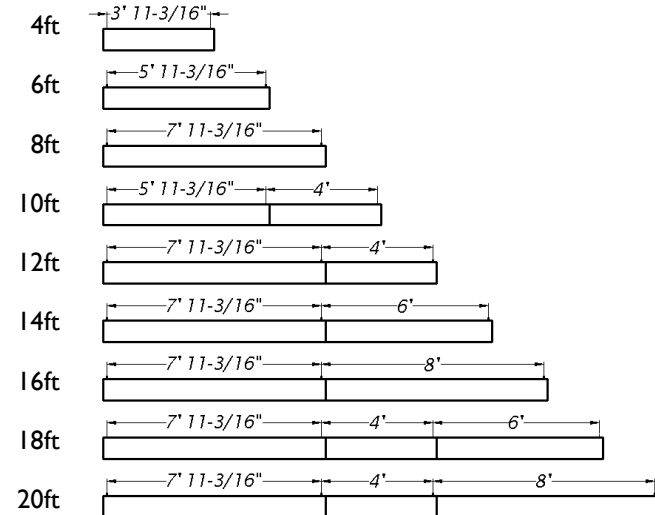

Row Configurations

The table below indicates how 4ft, 6ft, & 8ft modules can be combined to create continuous rows of various lengths.

Nominal row length	4'	6'	8'
4'	1x		
6'		1x	
8'			1x
10'	1x	1x	
12'	1x		1x
14'		1x	1x
16'			2x
18'	1x	1x	1x
20'	1x		2x

*Overall row lengths provided do not include endcaps. Add two endcaps to the overall length of each row.

1 Prepare fixtures / Install ceiling mounting components

Arrange boxed fixtures on the floor in specified mounting locations; remove fixtures & lightguide panels from boxes.

Install all ceiling mounting components and vertical aircraft cables using separate installation instructions for Aircraft Cable Mounting (supplied).

NOTE: If conditions are dusty/dirty, recommended practice is to leave fixtures in their plastic bag. Cut small holes in bag as needed to complete the following installation sequence, and then completely remove the bag from the fixture when conditions are clean.

2 Install end-of-row aircraft cable brackets

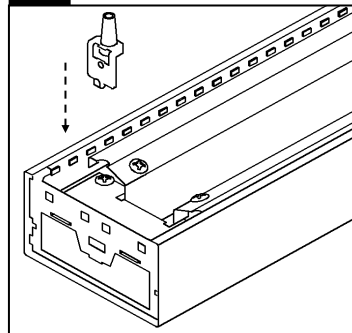

Fold rectangular flaps in wire cover and insert the A/C mounting bracket through the top. Raise bracket until security tab is engaged.

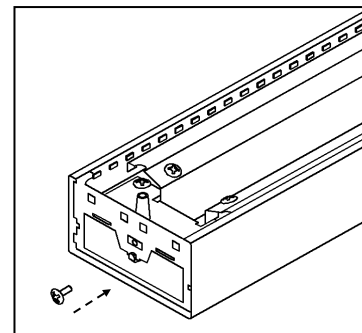

Attach brackets to fixture using supplied fasteners.

3 Suspend and level first fixture

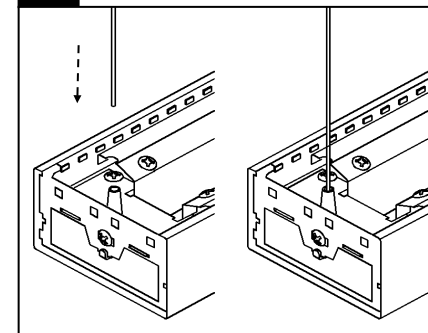

With two people, raise the first fixture to the ceiling. At each end of the module, insert aircraft cable into cable adjuster. The adjuster will automatically grip and hold the cable. **Do not force cable into adjuster.** See instruction A (page 3) for more details.

4 Complete electrical connections at end

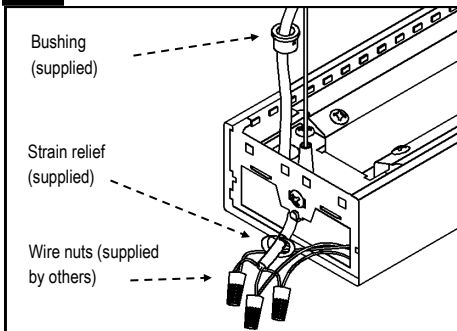

NON-POWER LOCATIONS: Cap all wires and tuck into wire cavity.

POWER LOCATIONS: Remove required 1/2" round knockout(s) in wire cover and insert supplied bushings(s). Insert power cord and apply strain relief below the wire cover to secure cord. Remove installed quick-wire connectors (if applicable) at power feed locations and complete electrical connections using wire nuts (supplied by others). Tuck wires into wire cavity.

5 Install in-row mount brackets and insert joiner aligners

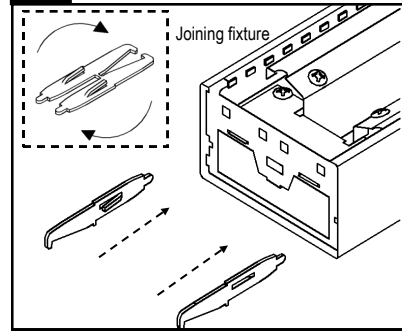

For each additional fixture in the row, at the end furthest from the existing suspended fixture, install the A/C mounting bracket as in step 2. **At the end closest to the existing suspended fixture,** insert joiner aligners into the crossplate (aligners will lock into place).

6 Suspend and join additional fixtures to create row

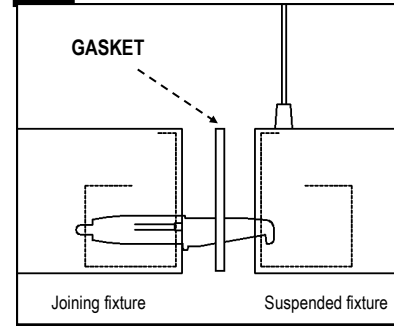

With two people, raise second fixture to ceiling.

At joint, insert joiner aligners through black **GASKET** and into suspended fixture. At other end of joining fixture, insert aircraft cable through adjuster.

IMPORTANT: Do not attempt to join fixtures on floor. Correct method is to hang one fixture at a time and join fixtures at ceiling level.

7 Complete electrical connections at joints

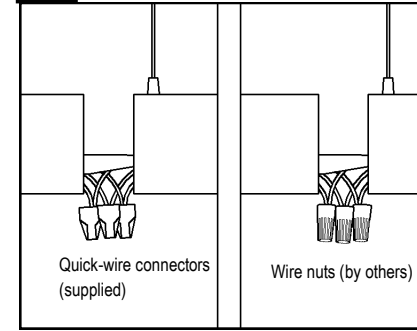

Complete in-row electrical connections.

NON-POWER LOCATIONS: Use supplied quick-wire connectors. Tuck wires into wire cavity.

POWER LOCATIONS: Remove installed quick-wire connectors and complete electrical connections using wire nuts (supplied by others). Tuck wires into wiring cavity.

! ATTENTION: Install in accordance with national and local building and electrical codes.

8 Secure joint(s)

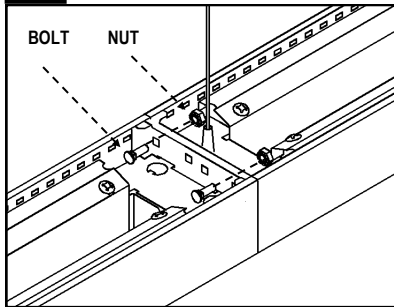

SLIDE MODULES TOGETHER: Secure joint from above using supplied bolts & nuts.

9 Install endcaps

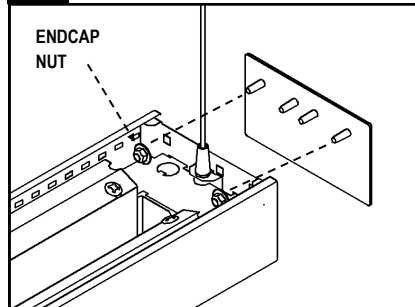

Attach endcap to first and last module in each row using supplied hardware. **11/32" NUT DRIVER OR WRENCH REQUIRED.**

IMPORTANT: Do not over-tighten endcap hardware. Tighten by hand. When nut is flush with cross-plate, turn additional 1/8 – 1/4 turn.

10 Install lightguide

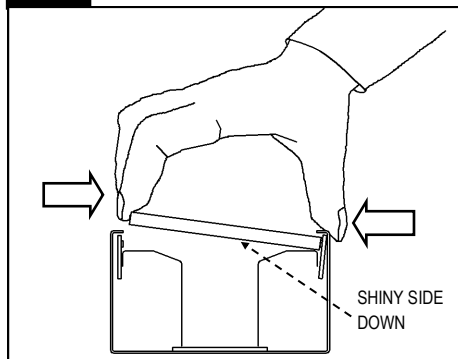

PEEL OFF PROTECTIVE FILM FROM BOTH SIDES OF LIGHTGUIDE PANEL

IMPORTANT: INSTALL LIGHTGUIDE PANEL SHINY SIDE DOWN

Locate one edge of the lightguide panel against LED's as shown. Using both hands, **squeeze together** housing and lightguide panel edge with thumb and fingers. Continuing to squeeze, quickly rotate lightguide into place. Ensure lightguide is installed correctly.

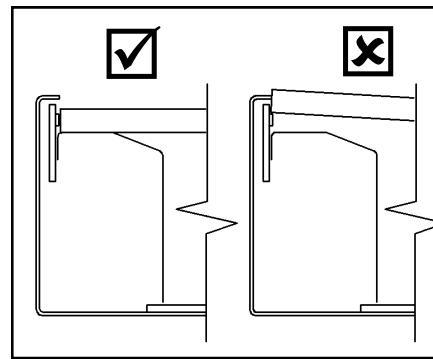

A Aircraft cable adjustment

IMPORTANT: Do not force cable into adjuster. To insert cable into adjuster, follow the steps below.

1. CUT

If required, cut cable ends cleanly prior to inserting into adjuster. Recommended cutters: K.K. Porter cable cutter cat No. 0690TN or Klein all-purpose shears cat No. 1104.

2. INSERT

Carefully insert cable into tapered end. If cable does not insert easily or becomes jammed, use the release tool to remove cable. Trim cable end again and repeat process. **DO NOT BEND CABLE BELOW BOTTOM OF ADJUSTER.**

3. TEST

Once Cable is inserted, apply a 25lb point load to each mount bracket to ensure all connections are secure.

NOTE: Ensure fixture is level end-to-end. Support fixture from below and use supplied aircraft cable release tool to make fine height adjustments.

This equipment has been tested and found to comply with the limits for a Class A digital device, pursuant to part 15 of the FCC Rules. These limits are designed to provide reasonable protection against harmful interference when the equipment is operated in a commercial environment. This equipment generates, uses, and can radiate radio frequency energy and, if not installed and used in accordance with the instruction manual, may cause harmful interference to radio communications. Operation of this equipment in a residential area is likely to cause harmful interference in which case the user will be required to correct the interference at his own expense.

B Level horizontally

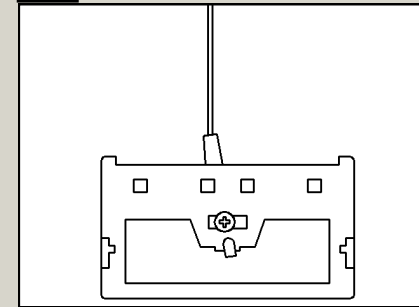

LEVEL HORIZONTALLY: Loosen fastener on bottom of adjuster and level as required. Tighten fastener once fixture is in

C Level vertically

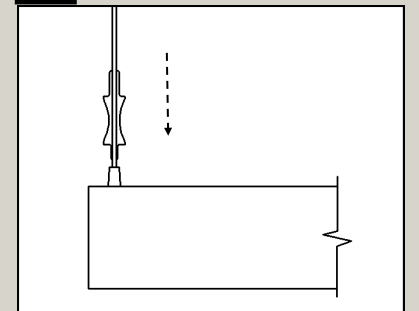

LEVEL VERTICALLY: Support fixture from below and use supplied cable gripper